

**HITECH**  
FASTENERS

# Hitech Fasteners, the big source for small fasteners

**2019**



An Australian Company

## CATEGORY 1

### STEEL MACHINE SCREWS METRIC & IMPERIAL

Pan Phillips  
Mush Phillips (Handle Screws)  
Pan Head Phillips  
Number Plate Screws  
Pan Pozi - Pan Slot  
Countersunk Phillips  
Countersunk Pozi  
Countersunk Slot  
Round Slot  
Cheese Combination  
Phillips/Slot

## CATEGORY 2

### UNIFIED & B.A MACHINE SCREWS

Pan Phillips  
Countersunk Phillips  
Cheese Slot  
Countersunk Slot

## CATEGORY 3

### BRASS SCREWS

Pan Slot  
Round Slot  
Countersunk Slot  
Cheese Combination  
Phillips/Slot  
Hexagon Brass Set Screws

## CATEGORY 4

### MUSH HEAD ROOFING BOLTS

Mush Head Combination  
Phillips/Slot - Roof Bolt Only  
Mush Head Combination  
Phillips/Slot - Roof Bolt & Nut  
Mush Nib Combination  
Phillips/Slot - (Paint Scraper)

## CATEGORY 5

### SEMS ASSEMBLY SCREW Complete with Captive Flat & Spring Washers

Pan 6-Lobe  
Pan Phillips

## CATEGORY 6

### SOLID STEEL RIVETS

Round Head  
Mush Head

## CATEGORY 7

### THREAD ROLLING SCREWS Steel Zinc & Waxed

HI-TITE (for metal)  
Pan 6-Lobe  
Pan Pozi  
Countersunk Undercut  
Countersunk Ribbed  
Indent Hex Washer Head  
HI-PLAS (for plastics)  
Pan 6-Lobe  
Pan Pozi

## CATEGORY 8

### SELF TAPPING SCREWS Type AB

Pan Phillips  
Pan Square/Phillips Combination  
Countersunk Phillips  
Countersunk  
Square/Phillips Combination  
Flange Head Phillips (Automotive)  
Assortment Kits

## CATEGORY 9

### NUTS

#### METRIC & IMPERIAL Unified & B.A

Cold Formed Hexagon -  
Metric, Imperial, Unified & B.A  
Steel Zinc & Brass  
Square Pressed Nuts - Steel Zinc  
Dome Nuts - Chrome &  
Galvanised  
Wing Nuts - Steel Zinc, Brass  
& Galvanised  
Flange Nuts - Steel Zinc Clear  
Tee Nuts - 4 Prong

## CATEGORY 10

### THUMB & WING SCREWS Steel Zinc Plated

Thumb Screw and Wing Screw

## CATEGORY 11

### PINS & CLIPS

Split Pins - R-Clips - Hi-Spring Clip  
Double Coil R-Clip  
Hair Pin Clips - Linch Pins  
Shaft Locking Pins  
Clevis Pins

## CATEGORY 12

### BRASS FLAT WASHERS

Brass Flat Washer

## CATEGORY 13

### SECURITY SCREWS

Post Combination  
Square/Phillips  
Case Hardened Zinc Alloy (Super  
Zinc) Plated Machine Screws

## CATEGORY 14

### U-DRIVE SCREWS

Round Head  
Zinc Clear

## CATEGORY 15

### DRIVER BITS - 1/4 A/F

6 Lobe - Phillips - Combination  
Square and Security

## CATEGORY 16

### SCREWS FOR TIMBER

SOLID BRASS Wood Screws  
STEEL BRASS PLATED Wood  
Screws Case Hardened

## CATEGORY 17

### HEXAGON MILD STEEL BOLTS & SET SCREWS

Hexagon Bolt & Nut  
Hexagon Set Screws

Category Headings are interactive. Just click on your selected category and the PDF will go to the selected category page. To return to Category Index click on [Index](#) at base of any page.

We offer solutions to fastener problems and the main solution we provide - without fail - is service. Get what you ordered when you need it, we follow your order every step of the way. To order email [info@hitechfasteners.com.au](mailto:info@hitechfasteners.com.au)

Our aim is to grow our business by expanding yours. Phone us on 02 9602 6200, and experience real service.

To us, solutions are more important than sales. We look forward to doing business with you.

# STEEL MACHINE SCREWS

## Metric & Imperial

Category I

**Pan Phillips**



2

**Mush Phillips (Handle Screws)**



3

**Pan Head Phillips  
Number Plate Screws**



3

**Pan Pozi**



4

**Pan Slot**



5

**Countersunk Phillips**



6

**Countersunk Pozi**



8

**Countersunk Slot**



9

**Round Slot**



10

**Cheese Combination  
Phillips/Slot**



11

### ***Plating / Material:***

Zinc Clear

Black Zinc

Mechanically Galvanised

### ***Specifications:***

Pan Metric:  $\leq$  M2      DIN 7985

Csk Metric: M2      DIN 965

Csk Metric: M12 & M16      JIS B1179

Metric:  $\geq$  M2.5-M10      AS 1427

Imperial: 1/8" - 3/8"      AS B50

Imperial: 1/2BSW      JIS B1179



# STEEL MACHINE SCREWS - Category I

**Pan Head**  
**PHILLIPS**  
**STEEL - METRIC**  
**ZINC PLATED**



<b>M 1.6</b>		Qty
MSPPZP164	1.6 x 4	200
MSPPZP166	1.6 x 6	200
MSPPZP168	1.6 x 8	200
MSPPZP1610	1.6 x 10	200

<b>M 2</b>		Qty
MSPPZP24	2 x 4	200
MSPPZP25	2 x 5	200
MSPPZP26	2 x 6	200
MSPPZP28	2 x 8	200
MSPPZP210	2 x 10	200
MSPPZP212	2 x 12	200
MSPPZP216	2 x 16	200
MSPPZP220	2 x 20	200

<b>M 2.5</b>		Qty
MSPPZP255	2.5 x 5	200
MSPPZP256	2.5 x 6	200
MSPPZP258	2.5 x 8	200
MSPPZP2510	2.5 x 10	200
MSPPZP2512	2.5 x 12	200
MSPPZP2516	2.5 x 16	200
MSPPZP2520	2.5 x 20	200
MSPPZP2525	2.5 x 25	200

<b>M 3</b>		Qty
MSPPZP35	3 x 5	200
MSPPZP36	3 x 6	200
MSPPZP38	3 x 8	200
MSPPZP310	3 x 10	200
MSPPZP312	3 x 12	200
MSPPZP316	3 x 16	200
MSPPZP320	3 x 20	200
MSPPZP325	3 x 25	200
MSPPZP330	3 x 30	200
MSPPZP335	3 x 35	200
MSPPZP340	3 x 40	200
MSPPZP350	3 x 50	200

<b>M 4</b>		Qty
MSPPZP45	4 x 5	200
MSPPZP46	4 x 6	200
MSPPZP48	4 x 8	200
MSPPZP410	4 x 10	200
MSPPZP412	4 x 12	200
MSPPZP416	4 x 16	200
MSPPZP420	4 x 20	200
MSPPZP425	4 x 25	200
MSPPZP430	4 x 30	200
MSPPZP435	4 x 35	200
MSPPZP440	4 x 40	200
MSPPZP445	4 x 45	200
MSPPZP450	4 x 50	200
MSPPZP460	4 x 60	200
MSPPZP465	4 x 65	200
MSPPZP470	4 x 70	200
MSPPZP475	4 x 75	200
MSPPZP4100	4 x 100	200

<b>M 5</b>		Qty
MSPPZP56	5 x 6	200
MSPPZP58	5 x 8	200
MSPPZP510	5 x 10	200
MSPPZP512	5 x 12	200
MSPPZP516	5 x 16	200
MSPPZP520	5 x 20	200
MSPPZP525	5 x 25	200
MSPPZP530	5 x 30	200
MSPPZP535	5 x 35	200
MSPPZP540	5 x 40	200
MSPPZP545	5 x 45	200
MSPPZP550	5 x 50	200
MSPPZP565	5 x 65	200
MSPPZP575	5 x 75	200
MSPPZP5100	5 x 100	200

<b>M 6</b>		Qty
MSPPZP68	6 x 8	200
MSPPZP610	6 x 10	200
MSPPZP612	6 x 12	200
MSPPZP616	6 x 16	200
MSPPZP620	6 x 20	200
MSPPZP625	6 x 25	200
MSPPZP630	6 x 30	200
MSPPZP635	6 x 35	200
MSPPZP640	6 x 40	200
MSPPZP645	6 x 45	200
MSPPZP650	6 x 50	200
MSPPZP665	6 x 65	100
MSPPZP675	6 x 75	100
MSPPZP6100	6 x 100	100

**Pan Head**  
**PHILLIPS**  
**STEEL - METRIC**  
**MECHANICALLY GALVANISED**



<b>M 6</b>		Qty
MSPPHP610	6 x 10	200
MSPPHP612	6 x 12	200
MSPPHP616	6 x 16	200
MSPPHP620	6 x 20	200

<b>M 6 Continued</b>		Qty
MSPPHP625	6 x 25	200
MSPPHP630	6 x 30	200
MSPPHP640	6 x 40	200
MSPPHP650	6 x 50	200

# STEEL MACHINE SCREWS - Category I

## Pan Head PHILLIPS STEEL - IMPERIAL ZINC PLATED



<b>1/8</b>		Qty
MSPPZP1814	1/8 x 1/4	200
MSPPZP1838	1/8 x 3/8	200
MSPPZP1812	1/8 x 1/2	200
MSPPZP1858	1/8 x 5/8	200
MSPPZP1834	1/8 x 3/4	200
MSPPZP181	1/8 x 1	200
MSPPZP18112	1/8 x 1 1/2	200
MSPPZP182	1/8 x 2	200
MSPPZP183	1/8 x 3	200

<b>5/32</b>		
MSPPZP53214	5/32 x 1/4	200
MSPPZP53238	5/32 x 3/8	200
MSPPZP53212	5/32 x 1/2	200
MSPPZP53258	5/32 x 5/8	200
MSPPZP53234	5/32 x 3/4	200
MSPPZP5321	5/32 x 1	200
MSPPZP532114	5/32 x 1 1/4	200
MSPPZP532112	5/32 x 1 1/2	200
MSPPZP5322	5/32 x 2	200
MSPPZP532214	5/32 x 2 1/4	200
MSPPZP532212	5/32 x 2 1/2	200
MSPPZP5323	5/32 x 3	200

<b>3/16</b>		Qty
MSPPZP31614	3/16 x 1/4	200
MSPPZP31638	3/16 x 3/8	200
MSPPZP31612	3/16 x 1/2	200
MSPPZP31658	3/16 x 5/8	200
MSPPZP31634	3/16 x 3/4	200
MSPPZP3161	3/16 x 1	200
MSPPZP316114	3/16 x 1 1/4	200
MSPPZP316112	3/16 x 1 1/2	200
MSPPZP316134	3/16 x 1 3/4	200
MSPPZP3162	3/16 x 2	200
MSPPZP316214	3/16 x 2 1/4	200
MSPPZP316212	3/16 x 2 1/2	200
MSPPZP3163	3/16 x 3	200
MSPPZP316312	3/16 x 3 1/2	200
MSPPZP3164	3/16 x 4	200

<b>1/4</b>		
MSPPZP1438	1/4 x 3/8	200
MSPPZP1412	1/4 x 1/2	200
MSPPZP1458	1/4 x 5/8	200
MSPPZP1434	1/4 x 3/4	200
MSPPZP141	1/4 x 1	200
MSPPZP14114	1/4 x 1 1/4	200

<b>1/4</b>	Continued	Qty
MSPPZP14112	1/4 x 1 1/2	200
MSPPZP14134	1/4 x 1 3/4	200
MSPPZP142	1/4 x 2	200
MSPPZP14212	1/4 x 2 1/2	100
MSPPZP143	1/4 x 3	100

<b>5/16</b>		Qty
MSPPZP51612	5/16 x 1/2	200
MSPPZP51634	5/16 x 3/4	200
MSPPZP5161	5/16 x 1	200
MSPPZP516114	5/16 x 1 1/4	200
MSPPZP516112	5/16 x 1 1/2	200
MSPPZP5162	5/16 x 2	100
MSPPZP516212	5/16 x 2 1/2	100
MSPPZP5163	5/16 x 3	100

<b>3/8</b>		
MSPPZP3834	3/8 x 3/4	200
MSPPZP381	3/8 x 1	200
MSPPZP38112	3/8 x 1 1/2	200
MSPPZP382	3/8 x 2	100
MSPPZP38212	3/8 x 2 1/2	100
MSPPZP383	3/8 x 3	100

## Mush Head PHILLIPS (Handle Screws) STEEL - METRIC ZINC PLATED



<b>M 4</b>		Qty
MSMPZP416	M4 x 16	200
MSMPZP420	M4 x 20	200
MSMPZP422	M4 x 22	200
MSMPZP428	M4 x 28	200

<b>M 4</b>	Continued	Qty
MSMPZP430	M4 x 30	200
MSMPZP432	M4 x 32	200
MSMPZP435	M4 x 35	200
MSMPZP440	M4 x 40	200

## Pan Head PHILLIPS STEEL NUMBER PLATE SCREW Small Head (10mm Dia.) - METRIC



<b>M 6</b>		Qty
MSNPSP620	6 x 20	200

# STEEL MACHINE SCREWS - Category I

**Pan Head**  
**PHILLIPS**  
**STEEL - METRIC**  
**BLACK ZINC PLATED**



<b>M 3</b>		Qty
MSPPBZP36	3 x 6	200
MSPPBZP38	3 x 8	200
MSPPBZP310	3 x 10	200
MSPPBZP312	3 x 12	200

<b>M 4</b>		Qty
MSPPBZP46	4 x 6	200
MSPPBZP48	4 x 8	200
MSPPBZP410	4 x 10	200

<b>M 4</b> Continued		Qty
MSPPBZP412	4 x 12	200
MSPPBZP416	4 x 16	200
MSPPBZP420	4 x 20	200
MSPPBZP425	4 x 25	200

<b>M 5</b>		Qty
MSPPBZP512	5 x 12	200
MSPPBZP516	5 x 16	200
MSPPBZP520	5 x 20	200
MSPPBZP525	5 x 25	200

<b>M 6</b>		Qty
MSPPBZP612	6 x 12	200
MSPPBZP616	6 x 16	200
MSPPBZP620	6 x 20	200
MSPPBZP625	6 x 25	200
MSPPBZP630	6 x 30	200

4

**Pan Head**  
**POZI**  
**STEEL - METRIC**  
**ZINC PLATED**



<b>M 2.5</b>		Qty
MSPZZP254	2.5 x 4	200
MSPZZP255	2.5 x 5	200
MSPZZP256	2.5 x 6	200
MSPZZP258	2.5 x 8	200
MSPZZP2510	2.5 x 10	200
MSPZZP2512	2.5 x 12	200
MSPZZP2516	2.5 x 16	200
MSPZZP2520	2.5 x 20	200
MSPZZP2525	2.5 x 25	200

<b>M 3</b>		Qty
MSPZZP35	3 x 5	200
MSPZZP36	3 x 6	200
MSPZZP38	3 x 8	200
MSPZZP310	3 x 10	200
MSPZZP312	3 x 12	200
MSPZZP316	3 x 16	200
MSPZZP320	3 x 20	200
MSPZZP325	3 x 25	200
MSPZZP330	3 x 30	200
MSPZZP335	3 x 35	200

<b>M 4</b>		Qty
MSPZZP46	4 x 6	200
MSPZZP48	4 x 8	200
MSPZZP410	4 x 10	200
MSPZZP412	4 x 12	200

<b>M 4</b> Continued		Qty
MSPZZP416	4 x 16	200
MSPZZP420	4 x 20	200
MSPZZP425	4 x 25	200
MSPZZP430	4 x 30	200
MSPZZP435	4 x 35	200
MSPZZP440	4 x 40	200
MSPZZP450	4 x 50	200

<b>M 5</b>		Qty
MSPZZP58	5 x 8	200
MSPZZP510	5 x 10	200
MSPZZP512	5 x 12	200
MSPZZP516	5 x 16	200
MSPZZP520	5 x 20	200
MSPZZP525	5 x 25	200
MSPZZP530	5 x 30	200
MSPZZP535	5 x 35	200
MSPZZP540	5 x 40	200
MSPZZP550	5 x 50	200

<b>M 6</b>		Qty
MSPZZP610	6 x 10	200
MSPZZP612	6 x 12	200
MSPZZP616	6 x 16	200
MSPZZP620	6 x 20	200
MSPZZP625	6 x 25	200
MSPZZP630	6 x 30	200

<b>M 6</b> Continued		Qty
MSPZZP635	6 x 35	200
MSPZZP640	6 x 40	200
MSPZZP650	6 x 50	200
MSPZZP665	6 x 65	100
MSPZZP675	6 x 75	100

<b>M 8</b>		Qty
MSPZZP812	8 x 12	200
MSPZZP816	8 x 16	200
MSPZZP820	8 x 20	200
MSPZZP825	8 x 25	200
MSPZZP830	8 x 30	200
MSPZZP835	8 x 35	200
MSPZZP840	8 x 40	200
MSPZZP850	8 x 50	200
MSPZZP865	8 x 65	100
MSPZZP875	8 x 75	100

<b>M 10</b>		Qty
MSPZZP1020	10 x 20	200
MSPZZP1025	10 x 25	200
MSPZZP1030	10 x 30	100
MSPZZP1040	10 x 40	100
MSPZZP1050	10 x 50	100
MSPZZP1065	10 x 65	100
MSPZZP1075	10 x 75	100

# STEEL MACHINE SCREWS - Category I

**Pan Head**  
**POZI**  
**STEEL - METRIC**  
**BLACK ZINC PLATED**



<b>M 3</b>		Qty
MSPZBZP36	3 x 6	200
MSPZBZP316	3 x 16	200
<b>M 4</b>		
MSPZBZP420	4 x 20	200
MSPZBZP430	4 x 30	200

<b>M 5</b>		Qty
MSPZBZP512	5 x 12	200
MSPZBZP516	5 x 16	200
MSPZBZP520	5 x 20	200
MSPZBZP525	5 x 25	200
MSPZBZP530	5 x 30	200

<b>M 6</b>		Qty
MSPZBZP620	6 x 20	200
MSPZBZP625	6 x 25	200
MSPZBZP630	6 x 30	200
MSPZBZP640	6 x 40	200
MSPZBZP650	6 x 50	200

**Pan Head**  
**SLOT**  
**STEEL - METRIC**  
**ZINC PLATED**



<b>M 2.5</b>		Qty
MSPSZP254	2.5 x 4	200
MSPSZP255	2.5 x 5	200
MSPSZP256	2.5 x 6	200
MSPSZP258	2.5 x 8	200
MSPSZP2510	2.5 x 10	200
MSPSZP2512	2.5 x 12	200
MSPSZP2516	2.5 x 16	200
MSPSZP2520	2.5 x 20	200
MSPSZP2525	2.5 x 25	200

<b>M 3</b>		
MSPSZP35	3 x 5	200
MSPSZP36	3 x 6	200
MSPSZP38	3 x 8	200
MSPSZP310	3 x 10	200
MSPSZP312	3 x 12	200
MSPSZP316	3 x 16	200
MSPSZP320	3 x 20	200
MSPSZP325	3 x 25	200
MSPSZP330	3 x 30	200
MSPSZP335	3 x 35	200

<b>M 3.5</b>		Qty
MSPSZP356	3.5 x 6	200
MSPSZP358	3.5 x 8	200
MSPSZP3510	3.5 x 10	200
MSPSZP3512	3.5 x 12	200

<b>M 3.5</b> Continued		Qty
MSPSZP3516	3.5 x 16	200
MSPSZP3520	3.5 x 20	200
MSPSZP3525	3.5 x 25	200

<b>M 4</b>		
MSPSZP45	4 x 5	200
MSPSZP46	4 x 6	200
MSPSZP48	4 x 8	200
MSPSZP410	4 x 10	200
MSPSZP412	4 x 12	200
MSPSZP416	4 x 16	200
MSPSZP420	4 x 20	200
MSPSZP425	4 x 25	200
MSPSZP430	4 x 30	200
MSPSZP435	4 x 35	200
MSPSZP440	4 x 40	200
MSPSZP450	4 x 50	200

<b>M 5</b>		
MSPSZP56	5 x 6	200
MSPSZP58	5 x 8	200
MSPSZP510	5 x 10	200
MSPSZP512	5 x 12	200
MSPSZP516	5 x 16	200
MSPSZP520	5 x 20	200
MSPSZP525	5 x 25	200
MSPSZP530	5 x 30	200

<b>M 5</b> Continued		Qty
MSPSZP540	5 x 40	200
MSPSZP550	5 x 50	200
MSPSZP565	5 x 65	200
MSPSZP575	5 x 75	200

<b>M 6</b>		
MSPSZP610	6 x 10	200
MSPSZP612	6 x 12	200
MSPSZP616	6 x 16	200
MSPSZP620	6 x 20	200
MSPSZP625	6 x 25	200
MSPSZP630	6 x 30	200
MSPSZP635	6 x 35	200
MSPSZP640	6 x 40	200
MSPSZP650	6 x 50	200
MSPSZP665	6 x 65	100
MSPSZP675	6 x 75	100

<b>M 8</b>		
MSPSZP820	8 x 20	100
MSPSZP825	8 x 25	100
MSPSZP830	8 x 30	100
MSPSZP840	8 x 40	100
MSPSZP850	8 x 50	100

<b>M 10</b>		
MSPSZP1050	10 x 50	100

# STEEL MACHINE SCREWS - Category I

**Countersunk Head**  
**PHILLIPS**  
**STEEL - METRIC**  
**ZINC PLATED**



<b>M 2</b>		Qty
MSCPZP25	2 x 5	200
MSCPZP26	2 x 6	200
MSCPZP28	2 x 8	200
MSCPZP210	2 x 10	200
MSCPZP212	2 x 12	200

<b>M 2.5</b>		Qty
MSCPZP255	2.5 x 5	200
MSCPZP256	2.5 x 6	200
MSCPZP258	2.5 x 8	200
MSCPZP2510	2.5 x 10	200
MSCPZP2512	2.5 x 12	200
MSCPZP2516	2.5 x 16	200
MSCPZP2520	2.5 x 20	200
MSCPZP2525	2.5 x 25	200

<b>M 3</b>		Qty
MSCPZP35	3 x 5	200
MSCPZP36	3 x 6	200
MSCPZP38	3 x 8	200
MSCPZP310	3 x 10	200
MSCPZP312	3 x 12	200
MSCPZP316	3 x 16	200
MSCPZP320	3 x 20	200
MSCPZP325	3 x 25	200
MSCPZP330	3 x 30	200
MSCPZP335	3 x 35	200
MSCPZP340	3 x 40	200
MSCPZP345	3 x 45	200
MSCPZP350	3 x 50	200

<b>M 4</b>		Qty
MSCPZP46	4 x 6	200
MSCPZP48	4 x 8	200
MSCPZP410	4 x 10	200
MSCPZP412	4 x 12	200
MSCPZP416	4 x 16	200
MSCPZP420	4 x 20	200
MSCPZP425	4 x 25	200
MSCPZP430	4 x 30	200
MSCPZP435	4 x 35	200
MSCPZP440	4 x 40	200
MSCPZP445	4 x 45	200
MSCPZP450	4 x 50	200
MSCPZP465	4 x 65	200
MSCPZP475	4 x 75	200

<b>M 5</b>		Qty
MSCPZP58	5 x 8	200
MSCPZP510	5 x 10	200
MSCPZP512	5 x 12	200
MSCPZP516	5 x 16	200
MSCPZP520	5 x 20	200
MSCPZP525	5 x 25	200
MSCPZP530	5 x 30	200
MSCPZP535	5 x 35	200
MSCPZP540	5 x 40	200
MSCPZP545	5 x 45	200
MSCPZP550	5 x 50	200
MSCPZP565	5 x 65	200
MSCPZP575	5 x 75	200

<b>M 6</b>		Qty
MSCPZP610	6 x 10	200
MSCPZP612	6 x 12	200
MSCPZP616	6 x 16	200
MSCPZP620	6 x 20	200
MSCPZP625	6 x 25	200
MSCPZP630	6 x 30	200
MSCPZP635	6 x 35	200
MSCPZP640	6 x 40	200
MSCPZP645	6 x 45	200
MSCPZP650	6 x 50	200
MSCPZP665	6 x 65	100
MSCPZP675	6 x 75	100



# STEEL MACHINE SCREWS - Category I

**Countersunk Head**  
**PHILLIPS**  
**STEEL - IMPERIAL**  
**ZINC PLATED**



<b>1/8</b>		Qty
MSCPZP1814	1/8 x 1/4	200
MSCPZP1838	1/8 x 3/8	200
MSCPZP1812	1/8 x 1/2	200
MSCPZP1834	1/8 x 3/4	200
MSCPZP181	1/8 x 1	200

<b>5/32</b>		Qty
MSCPZP53214	5/32 x 1/4	200
MSCPZP53238	5/32 x 3/8	200
MSCPZP53212	5/32 x 1/2	200
MSCPZP53258	5/32 x 5/8	200
MSCPZP53234	5/32 x 3/4	200
MSCPZP5321	5/32 x 1	200
MSCPZP532114	5/32 x 1 1/4	200
MSCPZP532112	5/32 x 1 1/2	200
MSCPZP532134	5/32 x 1 3/4	200
MSCPZP5322	5/32 x 2	200
MSCPZP532212	5/32 x 2 1/2	200
MSCPZP5323	5/32 x 3	200

<b>3/16</b>		Qty
MSCPZP31614	3/16 x 1/4	200
MSCPZP31638	3/16 x 3/8	200
MSCPZP31612	3/16 x 1/2	200
MSCPZP31658	3/16 x 5/8	200
MSCPZP31634	3/16 x 3/4	200
MSCPZP3161	3/16 x 1	200
MSCPZP316114	3/16 x 1 1/4	200
MSCPZP316112	3/16 x 1 1/2	200
MSCPZP316134	3/16 x 1 3/4	200
MSCPZP3162	3/16 x 2	200
MSCPZP316212	3/16 x 2 1/2	200
MSCPZP3163	3/16 x 3	200

<b>1/4</b>		Qty
MSCPZP1438	1/4 x 3/8	200
MSCPZP1412	1/4 x 1/2	200
MSCPZP1458	1/4 x 5/8	200
MSCPZP1434	1/4 x 3/4	200
MSCPZP141	1/4 x 1	200
MSCPZP14114	1/4 x 1 1/4	200
MSCPZP14112	1/4 x 1 1/2	200
MSCPZP14134	1/4 x 1 3/4	200
MSCPZP142	1/4 x 2	200
MSCPZP14212	1/4 x 2 1/2	100
MSCPZP143	1/4 x 3	100

<b>5/16</b>		Qty
MSCPZP51612	5/16 x 1/2	200
MSCPZP51634	5/16 x 3/4	200
MSCPZP5161	5/16 x 1	200
MSCPZP516114	5/16 x 1 1/4	200
MSCPZP516112	5/16 x 1 1/2	200
MSCPZP5162	5/16 x 2	100
MSCPZP516212	5/16 x 2 1/2	100
MSCPZP5163	5/16 x 3	100

<b>3/8</b>		Qty
MSCPZP3834	3/8 x 3/4	200
MSCPZP381	3/8 x 1	200
MSCPZP38114	3/8 x 1 1/4	200
MSCPZP38112	3/8 x 1 1/2	100
MSCPZP382	3/8 x 2	100
MSCPZP38212	3/8 x 2 1/2	100
MSCPZP383	3/8 x 3	100

# STEEL MACHINE SCREWS - Category I

**Countersunk Head**  
**POZI**  
**STEEL - METRIC**  
**ZINC PLATED**



<b>M 2.5</b>		Qty
MSCZZP255	2.5 x 5	200
MSCZZP256	2.5 x 6	200
MSCZZP258	2.5 x 8	200
MSCZZP2510	2.5 x 10	200
MSCZZP2512	2.5 x 12	200
MSCZZP2516	2.5 x 16	200
MSCZZP2520	2.5 x 20	200
MSCZZP2525	2.5 x 25	200

<b>M 3</b>		Qty
MSCZZP35	3 x 5	200
MSCZZP36	3 x 6	200
MSCZZP38	3 x 8	200
MSCZZP310	3 x 10	200
MSCZZP312	3 x 12	200
MSCZZP316	3 x 16	200
MSCZZP320	3 x 20	200
MSCZZP325	3 x 25	200
MSCZZP330	3 x 30	200

<b>M 4</b>		Qty
MSCZZP46	4 x 6	200
MSCZZP48	4 x 8	200
MSCZZP410	4 x 10	200
MSCZZP412	4 x 12	200
MSCZZP416	4 x 16	200
MSCZZP420	4 x 20	200
MSCZZP425	4 x 25	200

<b>M 4</b> Continued		Qty
MSCZZP430	4 x 30	200
MSCZZP435	4 x 35	200
MSCZZP440	4 x 40	200
MSCZZP450	4 x 50	200

<b>M5</b>		Qty
MSCZZP58	5 x 8	200
MSCZZP510	5 x 10	200
MSCZZP512	5 x 12	200
MSCZZP516	5 x 16	200
MSCZZP520	5 x 20	200
MSCZZP525	5 x 25	200
MSCZZP530	5 x 30	200
MSCZZP540	5 x 40	200
MSCZZP550	5 x 50	200

<b>M 6</b>		Qty
MSCZZP610	6 x 10	200
MSCZZP612	6 x 12	200
MSCZZP616	6 x 16	200
MSCZZP620	6 x 20	200
MSCZZP625	6 x 25	200
MSCZZP630	6 x 30	200
MSCZZP635	6 x 35	200
MSCZZP640	6 x 40	200
MSCZZP645	6 x 45	200
MSCZZP650	6 x 50	200
MSCZZP665	6 x 65	100
MSCZZP675	6 x 75	100

<b>M 8</b>		Qty
MSCZZP812	8 x 12	200
MSCZZP816	8 x 16	200
MSCZZP820	8 x 20	200
MSCZZP825	8 x 25	200
MSCZZP830	8 x 30	200
MSCZZP835	8 x 35	200
MSCZZP840	8 x 40	200
MSCZZP850	8 x 50	200
MSCZZP865	8 x 65	100
MSCZZP875	8 x 75	100

<b>M 10</b>		Qty
MSCZZP1020	10 x 20	200
MSCZZP1025	10 x 25	200
MSCZZP1030	10 x 30	100
MSCZZP1040	10 x 40	100
MSCZZP1050	10 x 50	100
MSCZZP1065	10 x 65	100
MSCZZP1075	10 x 75	100

**Countersunk Head**  
**POZI**  
**STEEL- METRIC**  
**BLACK ZINC PLATED**



<b>M 3</b>		Qty
MSCZBP36	3 x 6	200

<b>M 5</b>		Qty
MSCZBP516	5 x 16	200

# STEEL MACHINE SCREWS - Category I

**Countersunk Head**  
**SLOT**  
**STEEL- METRIC**  
**ZINC PLATED**



<b>M 2.5</b>		Qty
MSCSZP255	<b>2.5 x 5</b>	200
MSCSZP256	<b>2.5 x 6</b>	200
MSCSZP258	<b>2.5 x 8</b>	200
MSCSZP2510	<b>2.5 x 10</b>	200
MSCSZP2512	<b>2.5 x 12</b>	200
MSCSZP2516	<b>2.5 x 16</b>	200
MSCSZP2520	<b>2.5 x 20</b>	200
MSCSZP2525	<b>2.5 x 25</b>	200

<b>M 3</b>		Qty
MSCSZP35	<b>3 x 5</b>	200
MSCSZP36	<b>3 x 6</b>	200
MSCSZP38	<b>3 x 8</b>	200
MSCSZP310	<b>3 x 10</b>	200
MSCSZP312	<b>3 x 12</b>	200
MSCSZP316	<b>3 x 16</b>	200
MSCSZP320	<b>3 x 20</b>	200
MSCSZP325	<b>3 x 25</b>	200
MSCSZP330	<b>3 x 30</b>	200
MSCSZP335	<b>3 x 35</b>	200

<b>M 3.5</b>		Qty
MSCSZP356	<b>3.5 x 6</b>	200
MSCSZP3510	<b>3.5 x 10</b>	200
MSCSZP3512	<b>3.5 x 12</b>	200
MSCSZP3516	<b>3.5 x 16</b>	200
MSCSZP3520	<b>3.5 x 20</b>	200
MSCSZP3525	<b>3.5 x 25</b>	200

<b>M 4</b>		Qty
MSCSZP46	<b>4 x 6</b>	200
MSCSZP48	<b>4 x 8</b>	200
MSCSZP410	<b>4 x 10</b>	200
MSCSZP412	<b>4 x 12</b>	200
MSCSZP416	<b>4 x 16</b>	200
MSCSZP420	<b>4 x 20</b>	200
MSCSZP425	<b>4 x 25</b>	200
MSCSZP430	<b>4 x 30</b>	200
MSCSZP435	<b>4 x 35</b>	200
MSCSZP440	<b>4 x 40</b>	200
MSCSZP450	<b>4 x 50</b>	200

<b>M5</b>		Qty
MSCSZP58	<b>5 x 8</b>	200
MSCSZP510	<b>5 x 10</b>	200
MSCSZP512	<b>5 x 12</b>	200
MSCSZP516	<b>5 x 16</b>	200
MSCSZP520	<b>5 x 20</b>	200
MSCSZP525	<b>5 x 25</b>	200
MSCSZP530	<b>5 x 30</b>	200
MSCSZP540	<b>5 x 40</b>	200
MSCSZP550	<b>5 x 50</b>	200
MSCSZP565	<b>5 x 65</b>	200
MSCSZP575	<b>5 x 75</b>	200

<b>M 6</b>		Qty
MSCSZP610	<b>6 x 10</b>	200
MSCSZP612	<b>6 x 12</b>	200
MSCSZP616	<b>6 x 16</b>	200
MSCSZP620	<b>6 x 20</b>	200
MSCSZP625	<b>6 x 25</b>	200
MSCSZP630	<b>6 x 30</b>	200
MSCSZP635	<b>6 x 35</b>	200
MSCSZP640	<b>6 x 40</b>	200
MSCSZP650	<b>6 x 50</b>	200
MSCSZP665	<b>6 x 65</b>	100
MSCSZP675	<b>6 x 75</b>	100

<b>M 8</b>		Qty
MSCSZP812	<b>8 x 12</b>	200
MSCSZP816	<b>8 x 16</b>	200
MSCSZP820	<b>8 x 20</b>	200
MSCSZP825	<b>8 x 25</b>	200
MSCSZP830	<b>8 x 30</b>	200
MSCSZP835	<b>8 x 35</b>	200
MSCSZP840	<b>8 x 40</b>	200
MSCSZP850	<b>8 x 50</b>	200
MSCSZP865	<b>8 x 65</b>	100
MSCSZP875	<b>8 x 75</b>	100

<b>M 10</b>		Qty
MSCSZP1020	<b>10 x 20</b>	100
MSCSZP1025	<b>10 x 25</b>	100
MSCSZP1030	<b>10 x 30</b>	100
MSCSZP1035	<b>10 x 35</b>	100
MSCSZP1040	<b>10 x 40</b>	100
MSCSZP1050	<b>10 x 50</b>	100
MSCSZP1065	<b>10 x 65</b>	50
MSCSZP1075	<b>10 x 75</b>	50

<b>M 12</b>		Qty
MSCSZP1225	<b>12 x 25</b>	100
MSCSZP1230	<b>12 x 30</b>	100
MSCSZP1240	<b>12 x 40</b>	100
MSCSZP1250	<b>12 x 50</b>	100
MSCSZP1265	<b>12 x 65</b>	50

<b>M 16</b>		Qty
MSCSZP1640	<b>16 x 40</b>	50
MSCSZP1650	<b>16 x 50</b>	25
MSCSZP1665	<b>16 x 65</b>	25

# STEEL MACHINE SCREWS - Category I

## Countersunk Head SLOT STEEL - IMPERIAL ZINC PLATED



<b>1/8</b>		Qty
MSCSZP1814	1/8 x 1/4	200
MSCSZP1838	1/8 x 3/8	200
MSCSZP1812	1/8 x 1/2	200
MSCSZP1858	1/8 x 5/8	200
MSCSZP1834	1/8 x 3/4	200
MSCSZP181	1/8 x 1	200
MSCSZP18114	1/8 x 1 1/4	200
MSCSZP18112	1/8 x 1 1/2	200

<b>5/32</b>		Qty
MSCSZP53214	5/32 x 1/4	200
MSCSZP53238	5/32 x 3/8	200
MSCSZP53212	5/32 x 1/2	200
MSCSZP53258	5/32 x 5/8	200
MSCSZP53234	5/32 x 3/4	200
MSCSZP5321	5/32 x 1	200
MSCSZP532114	5/32 x 1 1/4	200
MSCSZP532112	5/32 x 1 1/2	200
MSCSZP532134	5/32 x 1 3/4	200
MSCSZP5322	5/32 x 2	200

<b>3/16</b>		Qty
MSCSZP31614	3/16 x 1/4	200
MSCSZP31638	3/16 x 3/8	200
MSCSZP31612	3/16 x 1/2	200
MSCSZP31658	3/16 x 5/8	200
MSCSZP31634	3/16 x 3/4	200
MSCSZP3161	3/16 x 1	200
MSCSZP316114	3/16 x 1 1/4	200
MSCSZP316112	3/16 x 1 1/2	200
MSCSZP316134	3/16 x 1 3/4	200
MSCSZP3162	3/16 x 2	200
MSCSZP316212	3/16 x 2 1/2	200
MSCSZP3163	3/16 x 3	200

<b>1/4</b>		Qty
MSCSZP1438	1/4 x 3/8	200
MSCSZP1412	1/4 x 1/2	200
MSCSZP1458	1/4 x 5/8	200
MSCSZP1434	1/4 x 3/4	200
MSCSZP141	1/4 x 1	200
MSCSZP14114	1/4 x 1 1/4	200

<b>1/4</b> Continued		Qty
MSCSZP14112	1/4 x 1 1/2	200
MSCSZP14134	1/4 x 1 3/4	200
MSCSZP142	1/4 x 2	200
MSCSZP14212	1/4 x 2 1/2	100
MSCSZP143	1/4 x 3	100

<b>5/16</b>		Qty
MSCSZP51612	5/16 x 1/2	100
MSCSZP51634	5/16 x 3/4	100
MSCSZP5161	5/16 x 1	100
MSCSZP516114	5/16 x 1 1/4	100
MSCSZP516112	5/16 x 1 1/2	100
MSCSZP5162	5/16 x 2	100

<b>1/2</b>		Qty
MSCSZP121	1/2 x 1	100
MSCSZP12114	1/2 x 1 1/4	100
MSCSZP12112	1/2 x 1 1/2	100
MSCSZP122	1/2 x 2	100

## Round Head SLOT STEEL - IMPERIAL ZINC PLATED



<b>1/8</b>		Qty
MSRSZP18316	1/8 x 3/16	200
MSRSZP1814	1/8 x 1/4	200
MSRSZP1838	1/8 x 3/8	200
MSRSZP1812	1/8 x 1/2	200
MSRSZP1858	1/8 x 5/8	200
MSRSZP1834	1/8 x 3/4	200
MSRSZP181	1/8 x 1	200
MSRSZP18114	1/8 x 1 1/4	200
MSRSZP18112	1/8 x 1 1/2	200
MSRSZP182	1/8 x 2	200

<b>5/32</b>		Qty
MSRSZP53214	5/32 x 1/4	200
MSRSZP53238	5/32 x 3/8	200
MSRSZP53212	5/32 x 1/2	200
MSRSZP53258	5/32 x 5/8	200
MSRSZP53234	5/32 x 3/4	200

<b>5/32</b> Continued		Qty
MSRSZP5321	5/32 x 1	200
MSRSZP532114	5/32 x 1 1/4	200
MSRSZP532112	5/32 x 1 1/2	200
MSRSZP532134	5/32 x 1 3/4	200
MSRSZP5322	5/32 x 2	200

<b>3/16</b>		Qty
MSRSZP31614	3/16 x 1/4	200
MSRSZP31638	3/16 x 3/8	200
MSRSZP31612	3/16 x 1/2	200
MSRSZP31658	3/16 x 5/8	200
MSRSZP31634	3/16 x 3/4	200
MSRSZP3161	3/16 x 1	200
MSRSZP316114	3/16 x 1 1/4	200
MSRSZP316112	3/16 x 1 1/2	200
MSRSZP316134	3/16 x 1 3/4	200
MSRSZP3162	3/16 x 2	200

<b>3/16</b> Continued		Qty
MSRSZP316212	3/16 x 2 1/2	200
MSRSZP3163	3/16 x 3	200

<b>1/4</b>		Qty
MSRSZP1438	1/4 x 3/8	200
MSRSZP1412	1/4 x 1/2	200
MSRSZP1458	1/4 x 5/8	200
MSRSZP1434	1/4 x 3/4	200
MSRSZP141	1/4 x 1	200
MSRSZP14114	1/4 x 1 1/4	200
MSRSZP14112	1/4 x 1 1/2	200
MSRSZP14134	1/4 x 1 3/4	200
MSRSZP142	1/4 x 2	200
MSRSZP14212	1/4 x 2 1/2	100
MSRSZP143	1/4 x 3	100

<b>5/16</b>		Qty
MSRSZP5161	5/16 x 1	200



## STEEL MACHINE SCREWS - Category I

**Cheese Head**  
**COMBINATION**  
**PHILLIPS/SLOT**  
**STEEL - METRIC**  
**ZINC PLATED**



<b>M 2.5</b>		Qty
MSCCZP255	2.5 x 5	200
MSCCZP256	2.5 x 6	200
MSCCZP258	2.5 x 8	200
MSCCZP2510	2.5 x 10	200
MSCCZP2512	2.5 x 12	200
MSCCZP2516	2.5 x 16	200
MSCCZP2520	2.5 x 20	200

<b>M 3</b>		Qty
MSCCZP36	3 x 6	200
MSCCZP38	3 x 8	200
MSCCZP310	3 x 10	200
MSCCZP312	3 x 12	200
MSCCZP316	3 x 16	200
MSCCZP320	3 x 20	200
MSCCZP325	3 x 25	200
MSCCZP330	3 x 30	200

<b>M 4</b>		Qty
MSCCZP46	4 x 6	200
MSCCZP48	4 x 8	200
MSCCZP410	4 x 10	200
MSCCZP412	4 x 12	200
MSCCZP416	4 x 16	200
MSCCZP420	4 x 20	200
MSCCZP425	4 x 25	200
MSCCZP430	4 x 30	200
MSCCZP440	4 x 40	200
MSCCZP450	4 x 50	200

<b>M 5</b>		Qty
MSCCZP58	5 x 8	200
MSCCZP510	5 x 10	200
MSCCZP512	5 x 12	200
MSCCZP516	5 x 16	200
MSCCZP520	5 x 20	200
MSCCZP525	5 x 25	200
MSCCZP530	5 x 30	200
MSCCZP540	5 x 40	200
MSCCZP550	5 x 50	200

<b>M 6</b>		Qty
MSCCZP610	6 x 10	200
MSCCZP612	6 x 12	200
MSCCZP616	6 x 16	200
MSCCZP620	6 x 20	200
MSCCZP625	6 x 25	200
MSCCZP630	6 x 30	200
MSCCZP640	6 x 40	200
MSCCZP650	6 x 50	200

**Cheese Head**  
**COMBINATION**  
**PHILLIPS/SLOT**  
**STEEL - IMPERIAL**  
**ZINC PLATED**



<b>1/8</b>		Qty
MSCCZP1814	1/8 x 1/4	200
MSCCZP1838	1/8 x 3/8	200
MSCCZP1812	1/8 x 1/2	200
MSCCZP1834	1/8 x 3/4	200
MSCCZP181	1/8 x 1	200

<b>5/32</b>		Qty
MSCCZP53214	5/32 x 1/4	200
MSCCZP53238	5/32 x 3/8	200
MSCCZP53212	5/32 x 1/2	200
MSCCZP53234	5/32 x 3/4	200
MSCCZP5321	5/32 x 1	200

<b>3/16</b>		Qty
MSCCZP31638	3/16 x 3/8	200
MSCCZP31612	3/16 x 1/2	200
MSCCZP31658	3/16 x 5/8	200
MSCCZP31634	3/16 x 3/4	200
MSCCZP3161	3/16 x 1	200
MSCCZP316112	3/16 x 1 1/2	200
MSCCZP3162	3/16 x 2	200

<b>1/4</b>		Qty
MSCCZP1438	1/4 x 3/8	200
MSCCZP1412	1/4 x 1/2	200
MSCCZP1458	1/4 x 5/8	200
MSCCZP1434	1/4 x 3/4	200
MSCCZP141	1/4 x 1	200
MSCCZP14114	1/4 x 1 1/4	200
MSCCZP14112	1/4 x 1 1/2	200
MSCCZP142	1/4 x 2	200

# UNIFIED & B.A MACHINE SCREWS

Category 2

**Pan Phillips**

**Countersunk Phillips**

**Cheese Slot**

**Countersunk Slot**

13

13

14

14

12

***Plating / Material:***

Zinc Clear

Brass

***Specifications:***

Unified: ANSI B18.6.3

B.A: AS B85

## UNIFIED & B.A MACHINE SCREWS - Category 2

### Pan Head PHILLIPS STEEL - UNIFIED ZINC PLATED



<b>2-56</b>		Qty
MSPPZP256316	2-56 x 3/16	200
MSPPZP25638	2-56 x 3/8	200
MSPPZP25612	2-56 x 1/2	200

<b>4-40</b>		Qty
MSPPZP44014	4-40 x 1/4	200
MSPPZP44038	4-40 x 3/8	200
MSPPZP44012	4-40 x 1/2	200
MSPPZP44034	4-40 x 3/4	200
MSPPZP4401	4-40 x 1	200
MSPPZP440112	4-40 x 1 1/2	200

<b>6-32</b>		Qty
MSPPZP63214	6-32 x 1/4	200
MSPPZP63238	6-32 x 3/8	200
MSPPZP63212	6-32 x 1/2	200
MSPPZP63234	6-32 x 3/4	200
MSPPZP6321	6-32 x 1	200
MSPPZP632112	6-32 x 1 1/2	200

<b>8-32</b>		Qty
MSPPZP83214	8-32 x 1/4	200
MSPPZP83238	8-32 x 3/8	200
MSPPZP83212	8-32 x 1/2	200
MSPPZP83234	8-32 x 3/4	200
MSPPZP8321	8-32 x 1	200
MSPPZP832112	8-32 x 1 1/2	200

<b>10-32 UNF</b>		Qty
MSPPZP103238	10-32 x 3/8	200
MSPPZP103212	10-32 x 1/2	200
MSPPZP103234	10-32 x 3/4	200
MSPPZP10321	10-32 x 1	200
MSPPZP1032112	10-32 x 1 1/2	200

### Countersunk Head PHILLIPS STEEL - UNIFIED ZINC PLATED



<b>2-56</b>		Qty
MSCPZP256316	2-56 x 3/16	200
MSCPZP25638	2-56 x 3/8	200
MSCPZP25612	2-56 x 1/2	200

<b>4-40</b>		Qty
MSCPZP44014	4-40 x 1/4	200
MSCPZP44012	4-40 x 1/2	200
MSCPZP44034	4-40 x 3/4	200
MSCPZP4401	4-40 x 1	200
MSCPZP440112	4-40 x 1 1/2	200

<b>6-32</b>		Qty
MSCPZP63214	6-32 x 1/4	200
MSCPZP63212	6-32 x 1/2	200
MSCPZP63234	6-32 x 3/4	200
MSCPZP6321	6-32 x 1	200
MSCPZP632112	6-32 x 1 1/2	200

<b>8-32</b>		Qty
MSCPZP83214	8-32 x 1/4	200
MSCPZP83212	8-32 x 1/2	200
MSCPZP83234	8-32 x 3/4	200
MSCPZP8321	8-32 x 1	200
MSCPZP832112	8-32 x 1 1/2	200

<b>10-32 UNF</b>		Qty
MSCPZP103238	10-32 x 3/8	200
MSCPZP103212	10-32 x 1/2	200
MSCPZP103234	10-32 x 3/4	200
MSCPZP10321	10-32 x 1	200
MSCPZP1032112	10-32 x 1 1/2	200

## UNIFIED & B.A MACHINE SCREWS - Category 2

### B.A Cheese Head SLOT STEEL - B.A ZINC PLATED



<b>2BA</b>		Qty
MSCHSZP2BA12	2BA x 1/2	200
MSCHSZP2BA34	2BA x 3/4	200
MSCHSZP2BA1	2BA x 1	200
MSCHSZP2BA112	2BA x 1 1/2	200

<b>4BA</b>		Qty
MSCHSZP4BA12	4BA x 1/2	200
MSCHSZP4BA34	4BA x 3/4	200
MSCHSZP4BA1	4BA x 1	200
MSCHSZP4BA112	4BA x 1 1/2	200

<b>6BA</b>		Qty
MSCHSZP6BA12	6BA x 1/2	200
MSCHSZP6BA34	6BA x 3/4	200
MSCHSZP6BA1	6BA x 1	200
MSCHSZP6BA112	6BA x 1 1/2	200

### B.A Countersunk Head SLOT STEEL - B.A ZINC PLATED



<b>2BA</b>		Qty
MSCSZP2BA12	2BA x 1/2	200
MSCSZP2BA34	2BA x 3/4	200
MSCSZP2BA1	2BA x 1	200
MSCSZP2BA112	2BA x 1 1/2	200

<b>4BA</b>		Qty
MSCSZP4BA12	4BA x 1/2	200
MSCSZP4BA34	4BA x 3/4	200
MSCSZP4BA1	4BA x 1	200
MSCSZP4BA112	4BA x 1 1/2	200

<b>6BA</b>		Qty
MSCSZP6BA12	6BA x 1/2	200
MSCSZP6BA34	6BA x 3/4	200
MSCSZP6BA1	6BA x 1	200
MSCSZP6BA112	6BA x 1 1/2	200

### B.A Cheese Head SLOT BRASS - B.A



<b>2BA</b>		Qty
BRCHSP2BA12	2BA x 1/2	200
BRCHSP2BA34	2BA x 3/4	200
BRCHSP2BA1	2BA x 1	200
BRCHSP2BA112	2BA x 1 1/2	200

<b>4BA</b>		Qty
BRCHSP4BA12	4BA x 1/2	200
BRCHSP4BA34	4BA x 3/4	200
BRCHSP4BA1	4BA x 1	200
BRCHSP4BA112	4BA x 1 1/2	200

<b>6BA</b>		Qty
BRCHSP6BA12	6BA x 1/2	200
BRCHSP6BA34	6BA x 3/4	200
BRCHSP6BA1	6BA x 1	200
BRCHSP6BA112	6BA x 1 1/2	200



### Pan Slot



16

### Round Slot



16

### Countersunk Slot



17

### Cheese Combination Phillips/Slot



18

### Hexagon Brass Set Screws



18

15

#### *Plating / Material:*

Brass

#### *Machine Screw Specifications:*

Metric: AS 1427

Imperial: AS B50

#### *Hexagon Set Screw Specifications:*

Metric: AS 1111.2

DIN 933

## BRASS SCREWS - Category 3

### Pan Head

### SLOT

### BRASS - METRIC



<b>M 2.5</b>		Qty
BRPSP256	2.5 x 6	200
BRPSP258	2.5 x 8	200
BRPSP2510	2.5 x 10	200
BRPSP2512	2.5 x 12	200
BRPSP2516	2.5 x 16	200
BRPSP2520	2.5 x 20	200
BRPSP2525	2.5 x 25	200

<b>M 3</b>		Qty
BRPSP35	3 x 5	200
BRPSP36	3 x 6	200
BRPSP38	3 x 8	200
BRPSP310	3 x 10	200
BRPSP312	3 x 12	200
BRPSP316	3 x 16	200
BRPSP320	3 x 20	200
BRPSP325	3 x 25	200
BRPSP330	3 x 30	200
BRPSP340	3 x 40	200
BRPSP350	3 x 50	200

<b>M 4</b>		Qty
BRPSP46	4 x 6	200
BRPSP48	4 x 8	200
BRPSP410	4 x 10	200
BRPSP412	4 x 12	200
BRPSP416	4 x 16	200
BRPSP420	4 x 20	200
BRPSP425	4 x 25	200
BRPSP430	4 x 30	200
BRPSP440	4 x 40	200
BRPSP450	4 x 50	200
BRPSP465	4 x 65	200

<b>M 5</b>		Qty
BRPSP56	5 x 6	200
BRPSP58	5 x 8	200
BRPSP510	5 x 10	200
BRPSP512	5 x 12	200
BRPSP516	5 x 16	200
BRPSP520	5 x 20	200
BRPSP525	5 x 25	200
BRPSP530	5 x 30	200
BRPSP540	5 x 40	200
BRPSP550	5 x 50	200

<b>M 6</b>		Qty
BRPSP610	6 x 10	200
BRPSP612	6 x 12	200
BRPSP616	6 x 16	200
BRPSP620	6 x 20	200
BRPSP625	6 x 25	200
BRPSP630	6 x 30	200
BRPSP640	6 x 40	200
BRPSP650	6 x 50	200

<b>M 8</b>		Qty
BRPSP820	8 x 20	50
BRPSP825	8 x 25	50
BRPSP830	8 x 30	50
BRPSP840	8 x 40	50
BRPSP850	8 x 50	50

<b>M 10</b>		Qty
BRPSP1020	10 x 20	50
BRPSP1025	10 x 25	50
BRPSP1030	10 x 30	50
BRPSP1040	10 x 40	50
BRPSP1050	10 x 50	50

### Round Head

### SLOT

### BRASS - IMPERIAL



<b>1/8</b>		Qty
BRRSP1814	1/8 x 1/4	200
BRRSP1838	1/8 x 3/8	200
BRRSP1812	1/8 x 1/2	200
BRRSP1858	1/8 x 5/8	200
BRRSP1834	1/8 x 3/4	200
BRRSP181	1/8 x 1	200
BRRSP18114	1/8 x 1 1/4	200
BRRSP18112	1/8 x 1 1/2	200
BRRSP182	1/8 x 2	200

<b>5/32</b>		Qty
BRRSP53214	5/32 x 1/4	200
BRRSP53238	5/32 x 3/8	200
BRRSP53212	5/32 x 1/2	200
BRRSP53258	5/32 x 5/8	200
BRRSP53234	5/32 x 3/4	200
BRRSP5321	5/32 x 1	200

<b>5/32</b> Continued		Qty
BRRSP532114	5/32 x 1 1/4	200
BRRSP532112	5/32 x 1 1/2	200
BRRSP5322	5/32 x 2	200

<b>3/16</b>		Qty
BRRSP31614	3/16 x 1/4	200
BRRSP31638	3/16 x 3/8	200
BRRSP31612	3/16 x 1/2	200
BRRSP31658	3/16 x 5/8	200
BRRSP31634	3/16 x 3/4	200
BRRSP3161	3/16 x 1	200
BRRSP316114	3/16 x 1 1/4	200
BRRSP316112	3/16 x 1 1/2	200
BRRSP316134	3/16 x 1 3/4	200
BRRSP3162	3/16 x 2	200
BRRSP316212	3/16 x 2 1/2	200
BRRSP3163	3/16 x 3	200

<b>1/4</b>		Qty
BRRSP1438	1/4 x 3/8	200
BRRSP1412	1/4 x 1/2	200
BRRSP1458	1/4 x 5/8	200
BRRSP1434	1/4 x 3/4	200
BRRSP141	1/4 x 1	200
BRRSP14114	1/4 x 1 1/4	200
BRRSP14112	1/4 x 1 1/2	200
BRRSP142	1/4 x 2	200
BRRSP14212	1/4 x 2 1/2	100
BRRSP143	1/4 x 3	100

<b>5/16</b>		Qty
BRRSP51634	5/16 x 3/4	50
BRRSP5161	5/16 x 1	50
BRRSP516112	5/16 x 1 1/2	50
BRRSP5162	5/16 x 2	50

## BRASS SCREWS - Category 3

### Countersunk Head SLOT BRASS - METRIC



<b>M 2.5</b>		Qty
BRCSP256	2.5 x 6	200
BRCSP258	2.5 x 8	200
BRCSP2510	2.5 x 10	200
BRCSP2512	2.5 x 12	200
BRCSP2516	2.5 x 16	200
BRCSP2520	2.5 x 20	200
BRCSP2525	2.5 x 25	200

<b>M 3</b>		Qty
BRCSP36	3 x 6	200
BRCSP38	3 x 8	200
BRCSP310	3 x 10	200
BRCSP312	3 x 12	200
BRCSP316	3 x 16	200
BRCSP320	3 x 20	200
BRCSP325	3 x 25	200
BRCSP330	3 x 30	200

<b>M 4</b>		Qty
BRCSP46	4 x 6	200
BRCSP48	4 x 8	200
BRCSP410	4 x 10	200
BRCSP412	4 x 12	200
BRCSP416	4 x 16	200
BRCSP420	4 x 20	200
BRCSP425	4 x 25	200
BRCSP430	4 x 30	200
BRCSP440	4 x 40	200
BRCSP450	4 x 50	200

<b>M 5</b>		Qty
BRCSP510	5 x 10	200
BRCSP512	5 x 12	200
BRCSP516	5 x 16	200
BRCSP520	5 x 20	200
BRCSP525	5 x 25	200
BRCSP530	5 x 30	200
BRCSP540	5 x 40	200
BRCSP550	5 x 50	200

<b>M 6</b>		Qty
BRCSP610	6 x 10	200
BRCSP612	6 x 12	200
BRCSP616	6 x 16	200
BRCSP620	6 x 20	200
BRCSP625	6 x 25	200
BRCSP630	6 x 30	200
BRCSP640	6 x 40	200
BRCSP650	6 x 50	200

<b>M 8</b>		Qty
BRCSP820	8 x 20	50
BRCSP825	8 x 25	50
BRCSP830	8 x 30	50
BRCSP840	8 x 40	50
BRCSP850	8 x 50	50

<b>M 10</b>		Qty
BRCSP1020	10 x 20	50
BRCSP1025	10 x 25	50
BRCSP1030	10 x 30	50
BRCSP1040	10 x 40	50
BRCSP1050	10 x 50	50

### Countersunk Head SLOT BRASS - IMPERIAL



<b>1/8</b>		Qty
BRCSP1814	1/8 x 1/4	200
BRCSP1838	1/8 x 3/8	200
BRCSP1812	1/8 x 1/2	200
BRCSP1834	1/8 x 3/4	200
BRCSP181	1/8 x 1	200
BRCSP18114	1/8 x 1 1/4	200
BRCSP18112	1/8 x 1 1/2	200
BRCSP182	1/8 x 2	200

<b>5/32</b>		Qty
BRCSP53238	5/32 x 3/8	200
BRCSP53212	5/32 x 1/2	200
BRCSP53234	5/32 x 3/4	200
BRCSP5321	5/32 x 1	200
BRCSP532114	5/32 x 1 1/4	200
BRCSP532112	5/32 x 1 1/2	200
BRCSP5322	5/32 x 2	200

<b>3/16</b>		Qty
BRCSP31614	3/16 x 1/4	200
BRCSP31638	3/16 x 3/8	200
BRCSP31612	3/16 x 1/2	200
BRCSP31658	3/16 x 5/8	200
BRCSP31634	3/16 x 3/4	200
BRCSP3161	3/16 x 1	200
BRCSP316114	3/16 x 1 1/4	200
BRCSP316112	3/16 x 1 1/2	200
BRCSP3162	3/16 x 2	200
BRCSP316212	3/16 x 2 1/2	200
BRCSP3163	3/16 x 3	200

<b>1/4</b>		Qty
BRCSP1412	1/4 x 1/2	200
BRCSP1458	1/4 x 5/8	200
BRCSP1434	1/4 x 3/4	200
BRCSP141	1/4 x 1	200

<b>1/4 Continued</b>		Qty
BRCSP14114	1/4 x 1 1/4	200
BRCSP14112	1/4 x 1 1/2	200
BRCSP142	1/4 x 2	200
BRCSP14212	1/4 x 2 1/2	100
BRCSP143	1/4 x 3	100

<b>5/16</b>		Qty
BRCSP51634	5/16 x 3/4	50
BRCSP5161	5/16 x 1	50
BRCSP516114	5/16 x 1 1/4	50
BRCSP516112	5/16 x 1 1/2	50
BRCSP5162	5/16 x 2	50

<b>3/8</b>		Qty
BRCSP3834	3/8 x 3/4	50
BRCSP381	3/8 x 1	50
BRCSP38112	3/8 x 1 1/2	50
BRCSP382	3/8 x 2	50

## BRASS SCREWS - Category 3

### Cheese Head COMBINATION PHILLIPS/SLOT BRASS - METRIC



<b>M 3</b>		Qty
BRCCP36	3 x 6	200
BRCCP38	3 x 8	200
BRCCP310	3 x 10	200
BRCCP312	3 x 12	200

<b>M 4</b>		Qty
BRCCP410	4 x 10	200
BRCCP412	4 x 12	200
BRCCP416	4 x 16	200
BRCCP420	4 x 20	200
BRCCP425	4 x 25	200

<b>M 6</b>		Qty
BRCCP612	6 x 12	200
BRCCP616	6 x 16	200
BRCCP620	6 x 20	200
BRCCP625	6 x 25	200

<b>M 5</b>		Qty
BRCCP510	5 x 10	200
BRCCP512	5 x 12	200
BRCCP516	5 x 16	200
BRCCP520	5 x 20	200
BRCCP525	5 x 25	200

18

### Hexagon Head SET SCREW BRASS - METRIC



<b>M 5</b>		Qty
BRHSP512	5 x 12	100
BRHSP516	5 x 16	100
BRHSP520	5 x 20	100
BRHSP525	5 x 25	100
BRHSP530	5 x 30	100
BRHSP535	5 x 35	100
BRHSP540	5 x 40	100
BRHSP545	5 x 45	100
BRHSP550	5 x 50	100

<b>M 8</b>		Qty
BRHSP812	8 x 12	50
BRHSP816	8 x 16	50
BRHSP820	8 x 20	50
BRHSP825	8 x 25	50
BRHSP830	8 x 30	50
BRHSP835	8 x 35	50
BRHSP840	8 x 40	50
BRHSP850	8 x 50	50

<b>M 12</b>		Qty
BRHSP1220	12 x 20	50
BRHSP1225	12 x 25	50
BRHSP1230	12 x 30	50
BRHSP1235	12 x 35	50
BRHSP1240	12 x 40	50
BRHSP1250	12 x 50	50
BRHSP1265	12 x 65	50
BRHSP1275	12 x 75	50

<b>M 6</b>		Qty
BRHSP612	6 x 12	100
BRHSP616	6 x 16	100
BRHSP620	6 x 20	100
BRHSP625	6 x 25	100
BRHSP630	6 x 30	100
BRHSP635	6 x 35	100
BRHSP640	6 x 40	100
BRHSP645	6 x 45	100
BRHSP650	6 x 50	100

<b>M 10</b>		Qty
BRHSP1016	10 x 16	50
BRHSP1020	10 x 20	50
BRHSP1025	10 x 25	50
BRHSP1030	10 x 30	50
BRHSP1035	10 x 35	50
BRHSP1040	10 x 40	50
BRHSP1050	10 x 50	50
BRHSP1065	10 x 65	50
BRHSP1075	10 x 75	50



### **Mush Head Combination Phillips/Slot Roof Bolt Only**



20

### **Mush Head Combination Phillips/Slot Roof Bolt & Nut**



21

### **Mush Nib Combination Phillips/Slot (Paint Scraper)**



21

19

#### ***Plating / Material:***

Zinc Clear

#### ***Specifications:***

Roof Bolts:	Refer Drawing
Nuts:	3/16 – ASB50
Nuts:	1/4 - 5/16 – AS 2451
Nuts:	M5 & M6 – AS 1112
Mush Nib:	Refer Drawing

## MUSH HEAD ROOFING BOLTS - Category 4

**Mush Head  
Roof Bolt Only  
PHILLIPS/SLOT  
STEEL - METRIC  
ZINC PLATED**



<b>M 5</b>		Qty
MSRBZP510	5 x 10	200
MSRBZP512	5 x 12	200
MSRBZP516	5 x 16	200
MSRBZP520	5 x 20	200
MSRBZP525	5 x 25	200

<b>M 6</b>		Qty
MSRBZP610	6 x 10	200
MSRBZP612	6 x 12	200
MSRBZP616	6 x 16	200
MSRBZP620	6 x 20	200
MSRBZP625	6 x 25	200
MSRBZP630	6 x 30	200
MSRBZP640	6 x 40	200
MSRBZP650	6 x 50	200

20

**Mush Head  
Roof Bolt Only  
PHILLIPS/SLOT  
STEEL - IMPERIAL**



<b>3/16</b>		Qty
MSRBZP31614	3/16 x 1/4	200
MSRBZP31638	3/16 x 3/8	200
MSRBZP31612	3/16 x 1/2	200
MSRBZP31658	3/16 x 5/8	200
MSRBZP31634	3/16 x 3/4	200
MSRBZP3161	3/16 x 1	200
MSRBZP316114	3/16 x 1 1/4	200
MSRBZP316112	3/16 x 1 1/2	200
MSRBZP316134	3/16 x 1 3/4	200
MSRBZP3162	3/16 x 2	200
MSRBZP316212	3/16 x 2 1/2	200
MSRBZP3163	3/16 x 3	200

<b>1/4</b>		Qty
MSRBZP1414	1/4 x 1/4	200
MSRBZP1438	1/4 x 3/8	200
MSRBZP1412	1/4 x 1/2	200
MSRBZP1458	1/4 x 5/8	200
MSRBZP1434	1/4 x 3/4	200
MSRBZP141	1/4 x 1	200
MSRBZP14114	1/4 x 1 1/4	200
MSRBZP14112	1/4 x 1 1/2	200
MSRBZP14134	1/4 x 1 3/4	200
MSRBZP142	1/4 x 2	200
MSRBZP14212	1/4 x 2 1/2	100
MSRBZP143	1/4 x 3	100

<b>5/16</b>		Qty
MSRBZP51612	5/16 x 1/2	200
MSRBZP51658	5/16 x 5/8	200
MSRBZP51634	5/16 x 3/4	200
MSRBZP5161	5/16 x 1	200
MSRBZP516114	5/16 x 1 1/4	200
MSRBZP516112	5/16 x 1 1/2	200
MSRBZP5162	5/16 x 2	200
MSRBZP516212	5/16 x 2 1/2	100
MSRBZP5163	5/16 x 3	100

## MUSH HEAD ROOFING BOLTS - Category 4

### Mush Head Roof Bolt and Nut PHILLIPS/SLOT STEEL - METRIC ZINC PLATED



M 5		Qty
MSRNZP510	5 x 10	200
MSRNZP512	5 x 12	200
MSRNZP516	5 x 16	200
MSRNZP520	5 x 20	200
MSRNZP525	5 x 25	200

M 6		Qty
MSRNZP610	6 x 10	200
MSRNZP612	6 x 12	200
MSRNZP616	6 x 16	200
MSRNZP620	6 x 20	200
MSRNZP625	6 x 25	200
MSRNZP630	6 x 30	200
MSRNZP640	6 x 40	200
MSRNZP650	6 x 50	200

### Mush Head Roof Bolt and Nut PHILLIPS/SLOT STEEL - IMPERIAL ZINC PLATED



3/16		Qty
MSRNZP31614	3/16 x 1/4	200
MSRNZP31638	3/16 x 3/8	200
MSRNZP31612	3/16 x 1/2	200
MSRNZP31658	3/16 x 5/8	200
MSRNZP31634	3/16 x 3/4	200
MSRNZP3161	3/16 x 1	200
MSRNZP316114	3/16 x 1 1/4	200
MSRNZP316112	3/16 x 1 1/2	200
MSRNZP316134	3/16 x 1 3/4	200
MSRNZP3162	3/16 x 2	200
MSRNZP316212	3/16 x 2 1/2	200
MSRNZP3163	3/16 x 3	200

1/4		Qty
MSRNZP1414	1/4 x 1/4	200
MSRNZP1438	1/4 x 3/8	200
MSRNZP1412	1/4 x 1/2	200
MSRNZP1458	1/4 x 5/8	200
MSRNZP1434	1/4 x 3/4	200
MSRNZP141	1/4 x 1	200
MSRNZP14114	1/4 x 1 1/4	200
MSRNZP14112	1/4 x 1 1/2	200
MSRNZP14134	1/4 x 1 3/4	200
MSRNZP142	1/4 x 2	200
MSRNZP14212	1/4 x 2 1/2	100
MSRNZP143	1/4 x 3	100

5/16		Qty
MSRNZP51612	5/16 x 1/2	200
MSRNZP51658	5/16 x 5/8	200
MSRNZP51634	5/16 x 3/4	200
MSRNZP5161	5/16 x 1	200
MSRNZP516114	5/16 x 1 1/4	200
MSRNZP516112	5/16 x 1 1/2	200
MSRNZP5162	5/16 x 2	200
MSRNZP516212	5/16 x 2 1/2	100
MSRNZP5163	5/16 x 3	100

### Mush Nib (Paint Scraper) PHILLIPS/SLOT STEEL - METRIC STEEL - IMPERIAL ZINC PLATED



M 5		Qty
MSMNZP512	5 x 12	200
MSMNZP525	5 x 25	200

3/16		Qty
MSMNZP31614	3/16 x 1/4	200
MSMNZP31638	3/16 x 3/8	200
MSMNZP31612	3/16 x 1/2	200
MSMNZP31658	3/16 x 5/8	200
MSMNZP31634	3/16 x 3/4	200

# SEMS ASSEMBLY SCREW

## Complete with captive Flat & Spring Washers

Category 5

**Pan 6-Lobe**

**Pan Phillips**



23

23

***Plating / Material:***

Zinc Clear

***Specifications:***

JIS B1188



## SEMS ASSEMBLY SCREW - Category 5

### Pan Head 6-LOBE SEMS STEEL - METRIC ZINC PLATED

Complete with captive  
flat & spring washers



<b>M 3</b>		Qty
MSPTSZP36	3 x 6	200
MSPTSZP38	3 x 8	200
MSPTSZP310	3 x 10	200
MSPTSZP312	3 x 12	200

<b>M 4</b>		Qty
MSPTSZP48	4 x 8	200
MSPTSZP410	4 x 10	200
MSPTSZP412	4 x 12	200
MSPTSZP416	4 x 16	200
MSPTSZP420	4 x 20	200

### Pan Head PHILLIPS SEMS STEEL - METRIC ZINC PLATED

Complete with captive  
flat & spring washers



<b>M 3</b>		Qty
MSPPSZP36	3 x 6	200
MSPPSZP38	3 x 8	200
MSPPSZP310	3 x 10	200
MSPPSZP312	3 x 12	200

<b>M 4</b>		Qty
MSPPSZP48	4 x 8	200
MSPPSZP410	4 x 10	200
MSPPSZP412	4 x 12	200
MSPPSZP416	4 x 16	200
MSPPSZP420	4 x 20	200

<b>M 5</b>		Qty
MSPPSZP510	M5 x 10	200
MSPPSZP512	M5 x 12	200
MSPPSZP516	M5 x 16	200
MSPPSZP520	M5 x 20	200
MSPPSZP525	M5 x 25	200

<b>M 6</b>		Qty
MSPPSZP610	M6 x 10	200
MSPPSZP612	M6 x 12	200
MSPPSZP616	M6 x 16	200
MSPPSZP620	M6 x 20	200
MSPPSZP625	M6 x 25	200
MSPPSZP630	M6 x 30	200

**Round Head**

**Mush Head**



25

25

***Plating / Material:***

Steel (no plating)

***Specifications:***

Steel: AS B118

## SOLID STEEL RIVETS- Category 6

### Round Head SOLID STEEL - IMPERIAL UNPLATED



<b>1/8</b>		Qty
MSRSRP1812	1/8 x 1/2	200
MSRSRP1834	1/8 x 3/4	200
MSRSRP181	1/8 x 1	200

<b>5/32</b>		
MSRSRP53238	5/32 x 3/8	200
MSRSRP53212	5/32 x 1/2	200
MSRSRP53234	5/32 x 3/4	200
MSRSRP5321	5/32 x 1	200

<b>3/16</b>		Qty
MSRSRP31638	3/16 x 3/8	200
MSRSRP31612	3/16 x 1/2	200
MSRSRP31634	3/16 x 3/4	200
MSRSRP3161	3/16 x 1	200

<b>1/4</b>		Qty
MSRSRP1412	1/4 x 1/2	200
MSRSRP1434	1/4 x 3/4	200
MSRSRP141	1/4 x 1	200

### Mush Head SOLID STEEL - IMPERIAL UNPLATED



<b>1/4</b>		Qty
MSMSRP1412	1/4 x 1/2	200
MSMSRP1434	1/4 x 3/4	200
MSMSRP141	1/4 x 1	200

# THREAD ROLLING SCREWS

Steel Zinc & Waxed

Category 7

## Hi-Tite (for metal)

### Pan 6-Lobe



27

### Pan Pozi



27

### Countersunk Undercut



28

### Countersunk Ribbed



28

### Indent Hex Washer Head



28

## Hi-Plas (for plastics)

### Pan 6-Lobe



29

### Pan Pozi



30

#### *Plating / Material:*

Steel Zinc & Waxed

#### *Specifications:*

Steel: DIN 7500

## THREAD ROLLING SCREWS - Category 7

**Pan Head**  
**6-LOBE HI-TITE**  
**STEEL - METRIC**  
**FOR METAL**  
*ZINC PLATED Thread*  
*Rolling Screws - Waxed*



<b>M 3</b>		Qty
MSPTHZP36	3 x 6	1,000
MSPTHZP38	3 x 8	1,000
MSPTHZP310	3 x 10	1,000
MSPTHZP312	3 x 12	1,000
MSPTHZP314	3 x 14	1,000

<b>M 4</b>		Qty
MSPTHZP48	4 x 8	1,000
MSPTHZP410	4 x 10	1,000
MSPTHZP412	4 x 12	1,000
MSPTHZP416	4 x 16	1,000
MSPTHZP420	4 x 20	1,000

<b>M 5</b>		Qty
MSPTHZP510	5 x 10	1,000
MSPTHZP512	5 x 12	1,000
MSPTHZP516	5 x 16	1,000
MSPTHZP520	5 x 20	1,000

<b>M 6</b>		Qty
MSPTHZP610	6 x 10	1,000
MSPTHZP612	6 x 12	1,000
MSPTHZP616	6 x 16	1,000
MSPTHZP620	6 x 20	1,000
MSPTHZP630	6 x 30	1,000

**Pan Head**  
**POZI HI-TITE**  
**STEEL - METRIC**  
**FOR METAL**  
*ZINC PLATED Thread*  
*Rolling Screws - Waxed*



<b>M 3</b>		Qty
MSPZHYP36	3 x 6	1,000
MSPZHYP38	3 x 8	1,000
MSPZHYP312	3 x 12	1,000

<b>M 4</b>		Qty
MSPZHYP46	4 x 6	1,000
MSPZHYP48	4 x 8	1,000
MSPZHYP410	4 x 10	1,000
MSPZHYP412	4 x 12	1,000
MSPZHYP416	4 x 16	1,000
MSPZHYP420	4 x 20	1,000

<b>M 5</b>		Qty
MSPZHYP58	5 x 8	1,000
MSPZHYP510	5 x 10	1,000
MSPZHYP512	5 x 12	1,000
MSPZHYP516	5 x 16	1,000
MSPZHYP520	5 x 20	1,000

<b>M 6</b>		Qty
MSPZHYP612	6 x 12	1,000
MSPZHYP616	6 x 16	1,000
MSPZHYP620	6 x 20	1,000
MSPZHYP625	6 x 25	1,000



## THREAD ROLLING SCREWS - Category 7

### Countersunk Phillips HI-TITE STEEL

#### FOR METAL

YELLOW ZINC PLATED  
Thread Rolling Screws -  
Waxed - RIBBED

#### 14#/M6

		Qty
MSCPHYP14112	14# x 1 1/2 (M6 x 38mm)	500



### Countersunk Phillips UNDERCUT HI-TITE STEEL - METRIC

#### FOR METAL

ZINC PLATED Thread  
Rolling Screws - Waxed

#### M 5

		Qty
MSCUTZP512	5 x 12	1,000



### Indent Hexagonal Washer Head HI-TITE STEEL - METRIC

#### FOR METAL

ZINC PLATED Thread  
Rolling Screws - Waxed

#### M 6

		Qty
MSIHWHZP616	M6 x 16	1,000



#### M 8

		Qty
MSIHWHZP816	M8 x 16	200
MSIHWHZP820	M8 x 20	200
MSIHWHZP830	M8 x 30	200
MSIHWHZP840	M8 x 40	200
MSIHWHZP850	M8 x 50	200

#### M 10

		Qty
MSIHWHZP1020	M10 x 20	200
MSIHWHZP1030	M10 x 30	200
MSIHWHZP1040	M10 x 40	200
MSIHWHZP1050	M10 x 50	200

#### M 12

MSIHWHZP1230	M12 x 30	200
--------------	----------	-----

### HI-TITE TRILOBULAR Thread Rolling Screws - Recommended pilot hole sizes for various METAL thicknesses

#### FOR METAL

Nominal Size	Material thickness mm	Pilot hole mm	Drill size mm	Material thickness mm	Pilot hole mm	Drill size mm	Material thickness mm	Pilot hole mm	Drill size mm	Material thickness mm	Pilot hole mm	Drill size mm	Material thickness mm	Pilot hole mm	Drill size mm
M3 x 0.5	0.5 - 1.1	2.71	No 36 2.71	1.1 - 1.7	2.72	No 36 2.71	1.7 - 2.17	2.74	2.75	2.75-3.3	2.76	2.75	3.3-4.0	2.77	7/64" 2.78
M4 x 0.7	0.8 - 1.4	3.59	3.6	1.4 - 2.4	3.61	3.6	2.4 - 3.3	3.64	No 27 3.66	3.3-4.4	3.66	No 27 3.66	4.4-5.5	3.68	3.7
M5 x 0.8	1.0 - 2.1	4.53	4.5	2.1 - 2.9	4.56	No 15 4.57	2.9 - 4.4	4.58	No 15 4.57	4.4-5.9	4.61	4.6	5.9-7.1	4.6	No 14 4.62
M6 x 1.0	1.2 - 2.4	5.42	No 3 5.41	2.4 - 3.6	5.45	No 3 5.41	3.6 - 4.9	5.48	5.5	4.9-6.9	5.51	5.5	6.9-8.1	5.55	7/32" 5.56
M8 x 1.25	2.5 - 3.5	7.30		4.0 - 5.5	7.35		6.0 - 7.5	7.35		>8-<12	7.40				
M10 x 1.5	2.5 - 3.5	9.20		4.0 - 7.0	9.30		7.5 - 10	9.40		>10-<15	9.50				
M12 x 1.75	2.4 - 4.9	10.98	11.0	4.9 - 7.4	11.03	11.0	7.4 - 10.5	11.09	7/16" 11.11	10.5 - 14.5	11.5	7/16" 11.11	14.5 - 17.0	11.2	7/16" 11.11

## THREAD ROLLING SCREWS - Category 7

**Indent Hexagonal  
Washer Head  
HI-TITE STEEL - METRIC**

**FOR METAL**

**MECHANICALLY  
GALVANISED 25 Microns**



<b>M 8</b>		Qty
MSIHWHP816	<b>M8 x 16</b>	200
MSIHWHP820	<b>M8 x 20</b>	200
MSIHWHP830	<b>M8 x 30</b>	200
MSIHWHP840	<b>M8 x 40</b>	200
MSIHWHP850	<b>M8 x 50</b>	200

<b>M 10</b>		Qty
MSIHWHP1020	<b>M10 x 20</b>	200
MSIHWHP1030	<b>M10 x 30</b>	200
MSIHWHP1040	<b>M10 x 40</b>	200
MSIHWHP1050	<b>M10 x 50</b>	200

<b>M 12</b>		Qty
MSIHWHP1230	<b>M12 x 30</b>	200

**Go to next page for Thread Rolling Screws FOR PLASTIC**

## THREAD ROLLING SCREWS - Category 7

### Pan Head 6-LOBE HI-PLAS STEEL - METRIC

#### FOR PLASTICS

ZINC PLATED Thread  
Rolling Screws - Waxed

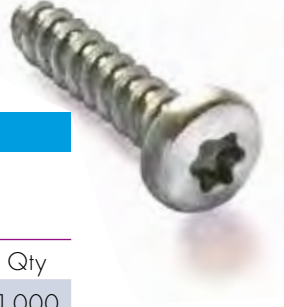

#### M 4

Qty

MSPTPZP412	4 x 12	1,000
------------	--------	-------

#### M 5

MSPTPZP520	5 x 20	1,000
------------	--------	-------

### Pan Head POZI HI-PLAS STEEL - METRIC

#### FOR PLASTICS

ZINC PLATED Thread  
Rolling Screws - Waxed



#### M 2.5

Qty

MSPZPZP256	2.5 x 6	1,000
MSPZPZP258	2.5 x 8	1,000
MSPZPZP2510	2.5 x 10	1,000
MSPZPZP2512	2.5 x 12	1,000

#### M 3

MSPZPZP36	3 x 6	1,000
MSPZPZP38	3 x 8	1,000
MSPZPZP310	3 x 10	1,000
MSPZPZP312	3 x 12	1,000

#### M 4

Qty

MSPZPZP48	4 x 8	1,000
MSPZPZP410	4 x 10	1,000
MSPZPZP412	4 x 12	1,000
MSPZPZP416	4 x 16	1,000
MSPZPZP420	4 x 20	1,000

#### M 5

Qty

MSPZPZP510	5 x 10	1,000
MSPZPZP512	5 x 12	1,000
MSPZPZP516	5 x 16	1,000
MSPZPZP520	5 x 20	1,000

#### M 6

MSPZPZP612	6 x 12	1,000
MSPZPZP616	6 x 16	1,000
MSPZPZP620	6 x 20	1,000
MSPZPZP625	6 x 25	1,000

#### FOR PLASTICS

**HI-PLAS TRILOBULAR Thread Rolling Screws -**  
Recommended pilot hole sizes for various PLASTIC thicknesses

Nominal Size	MATERIAL THICKNESS							
	0.8	1.0	1.2	1.6	2.0	2.6	3.2	4.0
M2.5	2.10	2.10	2.10	2.10	2.15	2.15	2.15	2.15
M3	2.50	2.50	2.50	2.50	2.60	2.60	2.60	2.60
M4	3.44	3.44	3.44	3.44	3.55	3.55	3.55	3.55
M5	4.37	4.37	4.37	4.37	4.45	4.45	4.45	4.45
M6	5.26	5.26	5.26	5.26	5.35	5.35	5.35	5.35

All table measurements are in mm

# SELF TAPPING SCREWS

## Type AB

Category 8

### Pan Phillips



32

### Pan Square/Phillips Combination



33

### Countersunk Phillips



34

### Countersunk Square/Phillips Combination



35

### Flange Head Phillips (Automotive)



37

### Pan and Countersunk Black Zinc



37

### Assortment Kits



33 36 38

#### **Plating / Material:**

Zinc Clear

Black Zinc

Mechanically Galvanised

#### **Specifications:**

Pan & Csk: ANSI B 18.6.4

Flange: AS B194

31

## SELF TAPPING SCREWS - Category 8

**Pan Head**  
**PHILLIPS**  
**STEEL - IMPERIAL**  
**ZINC PLATED**



2#		Qty
MSPPTZP214	2# x 1/4	1,000
MSPPTZP238	2# x 3/8	1,000
MSPPTZP212	2# x 1/2	1,000

4#		
MSPPTZP414	4# x 1/4	1,000
MSPPTZP438	4# x 3/8	1,000
MSPPTZP412	4# x 1/2	1,000
MSPPTZP458	4# x 5/8	1,000
MSPPTZP434	4# x 3/4	1,000
MSPPTZP41	4# x 1	1,000

6#		
MSPPTZP614	6# x 1/4	1,000
MSPPTZP638	6# x 3/8	1,000
MSPPTZP612	6# x 1/2	1,000
MSPPTZP658	6# x 5/8	1,000
MSPPTZP634	6# x 3/4	1,000
MSPPTZP61	6# x 1	1,000
MSPPTZP6114	6# x 1 1/4	1,000
MSPPTZP6112	6# x 1 1/2	1,000
MSPPTZP62	6# x 2	1,000

8#		Qty
MSPPTZP838	8# x 3/8	1,000
MSPPTZP812	8# x 1/2	1,000
MSPPTZP858	8# x 5/8	1,000
MSPPTZP834	8# x 3/4	1,000
MSPPTZP81	8# x 1	1,000
MSPPTZP8114	8# x 1 1/4	1,000
MSPPTZP8112	8# x 1 1/2	1,000
MSPPTZP8134	8# x 1 3/4	1,000
MSPPTZP82	8# x 2	1,000
MSPPTZP8212	8# x 2 1/2	1,000
MSPPTZP83	8# x 3	1,000

10#		
MSPPTZP1038	10# x 3/8	1,000
MSPPTZP1012	10# x 1/2	1,000
MSPPTZP1058	10# x 5/8	1,000
MSPPTZP1034	10# x 3/4	1,000
MSPPTZP101	10# x 1	1,000
MSPPTZP10114	10# x 1 1/4	1,000
MSPPTZP10112	10# x 1 1/2	1,000
MSPPTZP10134	10# x 1 3/4	1,000
MSPPTZP102	10# x 2	1,000
MSPPTZP10212	10# x 2 1/2	500
MSPPTZP103	10# x 3	500

12#		Qty
MSPPTZP1212	12# x 1/2	1,000
MSPPTZP1258	12# x 5/8	1,000
MSPPTZP1234	12# x 3/4	1,000
MSPPTZP121	12# x 1	1,000
MSPPTZP12114	12# x 1 1/4	1,000
MSPPTZP12112	12# x 1 1/2	1,000
MSPPTZP12134	12# x 1 3/4	1,000
MSPPTZP122	12# x 2	1,000
MSPPTZP12212	12# x 2 1/2	500
MSPPTZP123	12# x 3	500

14#		
MSPPTZP1412	14# x 1/2	1,000
MSPPTZP1458	14# x 5/8	1,000
MSPPTZP1434	14# x 3/4	1,000
MSPPTZP141	14# x 1	1,000
MSPPTZP14114	14# x 1 1/4	1,000
MSPPTZP14112	14# x 1 1/2	1,000
MSPPTZP14134	14# x 1 3/4	1,000
MSPPTZP142	14# x 2	1,000
MSPPTZP14212	14# x 2 1/2	500
MSPPTZP143	14# x 3	500

**Pan Head**  
**PHILLIPS**  
**STEEL - IMPERIAL**  
**MECHANICALLY**  
**GALVANISED (15um)**



6#		Qty
MSPPTHP638	6# x 3/8	1,000
MSPPTHP612	6# x 1/2	1,000
MSPPTHP634	6# x 3/4	1,000
MSPPTHP61	6# x 1	1,000

8#		Qty
MSPPTHP838	8# x 3/8	1,000
MSPPTHP812	8# x 1/2	1,000
MSPPTHP834	8# x 3/4	1,000
MSPPTHP81	8# x 1	1,000

10#		Qty
MSPPTHP101	10# x 1	1,000



## SELF TAPPING SCREWS - Category 8

### Pan Head SQUARE/PHILLIPS COMBINATION STEEL - IMPERIAL ZINC PLATED



4 #		Qty
MSPCTZP414	4# x 1/4	1,000
MSPCTZP438	4# x 3/8	1,000
MSPCTZP412	4# x 1/2	1,000
MSPCTZP458	4# x 5/8	1,000
MSPCTZP434	4# x 3/4	1,000
MSPCTZP41	4# x 1	1,000

6 #		
MSPCTZP614	6# x 1/4	1,000
MSPCTZP638	6# x 3/8	1,000
MSPCTZP612	6# x 1/2	1,000
MSPCTZP658	6# x 5/8	1,000
MSPCTZP634	6# x 3/4	1,000
MSPCTZP61	6# x 1	1,000
MSPCTZP6114	6# x 1 1/4	1,000
MSPCTZP6112	6# x 1 1/2	1,000

8 #		Qty
MSPCTZP838	8# x 3/8	1,000
MSPCTZP812	8# x 1/2	1,000
MSPCTZP858	8# x 5/8	1,000
MSPCTZP834	8# x 3/4	1,000
MSPCTZP81	8# x 1	1,000
MSPCTZP8114	8# x 1 1/4	1,000
MSPCTZP8112	8# x 1 1/2	1,000
MSPCTZP8134	8# x 1 3/4	1,000
MSPCTZP82	8# x 2	1,000

10 #		
MSPCTZP1038	10# x 3/8	1,000
MSPCTZP1012	10# x 1/2	1,000
MSPCTZP1058	10# x 5/8	1,000
MSPCTZP1034	10# x 3/4	1,000
MSPCTZP101	10# x 1	1,000
MSPCTZP10114	10# x 1 1/4	1,000
MSPCTZP10112	10# x 1 1/2	1,000
MSPCTZP10134	10# x 1 3/4	1,000
MSPCTZP102	10# x 2	1,000

12 #		Qty
MSPCTZP1212	12# x 1/2	1,000
MSPCTZP1258	12# x 5/8	1,000
MSPCTZP1234	12# x 3/4	1,000
MSPCTZP121	12# x 1	1,000
MSPCTZP12114	12# x 1 1/4	1,000
MSPCTZP12112	12# x 1 1/2	1,000
MSPCTZP12134	12# x 1 3/4	1,000
MSPCTZP122	12# x 2	1,000

14 #		
MSPCTZP1412	14# x 1/2	1,000
MSPCTZP1458	14# x 5/8	1,000
MSPCTZP1434	14# x 3/4	1,000
MSPCTZP141	14# x 1	1,000
MSPCTZP14114	14# x 1 1/4	1,000
MSPCTZP14112	14# x 1 1/2	1,000
MSPCTZP142	14# x 2	1,000

### Pan Combination SQUARE/PHILLIPS Self Tapper Grab Kit ASSORTMENT PACK ZINC PLATED 4 to 10 Gauge Diameters



SELF TAPPER KIT	Qty
STPANKIT12	12 Sizes 2,400

#### SELF TAPPER KIT SPANKIT12 - CONTENTS AND QUANTITIES

Part Number	Size	Qty. per Kit	Part Number	Size	Qty. per Kit
MSPCTZP414	4# x 1/4	500	MSPCTZP838	8# x 3/8	200
MSPCTZP438	4# x 3/8	500	MSPCTZP812	8# x 1/2	200
MSPCTZP638	6# x 3/8	200	MSPCTZP834	8# x 3/4	100
MSPCTZP612	6# x 1/2	200	MSPCTZP81	8# x 1	100
MSPCTZP634	6# x 3/4	100	MSPCTZP1012	10# x 1/2	100
MSPCTZP61	6# x 1	100	MSPCTZP1034	10# x 3/4	100

## SELF TAPPING SCREWS - Category 8

**Countersunk Head**  
**PHILLIPS**  
**STEEL - IMPERIAL**  
**ZINC PLATED**



4 #		Qty
MSCPTZP414	4# x 1/4	1,000
MSCPTZP438	4# x 3/8	1,000
MSCPTZP412	4# x 1/2	1,000
MSCPTZP458	4# x 5/8	1,000
MSCPTZP434	4# x 3/4	1,000
MSCPTZP41	4# x 1	1,000

5 #		
MSCPTZP512	5# x 1/2	1,000
MSCPTZP558	5# x 5/8	1,000
MSCPTZP534	5# x 3/4	1,000
MSCPTZP51	5# x 1	1,000

6 #		
MSCPTZP638	6# x 3/8	1,000
MSCPTZP612	6# x 1/2	1,000
MSCPTZP658	6# x 5/8	1,000
MSCPTZP634	6# x 3/4	1,000
MSCPTZP61	6# x 1	1,000
MSCPTZP6114	6# x 1 1/4	1,000
MSCPTZP6112	6# x 1 1/2	1,000

8 #		Qty
MSCPTZP838	8# x 3/8	1,000
MSCPTZP812	8# x 1/2	1,000
MSCPTZP858	8# x 5/8	1,000
MSCPTZP834	8# x 3/4	1,000
MSCPTZP81	8# x 1	1,000
MSCPTZP8114	8# x 1 1/4	1,000
MSCPTZP8112	8# x 1 1/2	1,000
MSCPTZP8134	8# x 1 3/4	1,000
MSCPTZP82	8# x 2	1,000

10 #		
MSCPTZP1038	10# x 3/8	1,000
MSCPTZP1012	10# x 1/2	1,000
MSCPTZP1058	10# x 5/8	1,000
MSCPTZP1034	10# x 3/4	1,000
MSCPTZP101	10# x 1	1,000
MSCPTZP10114	10# x 1 1/4	1,000
MSCPTZP10112	10# x 1 1/2	1,000
MSCPTZP10134	10# x 1 3/4	1,000
MSCPTZP102	10# x 2	1,000
MSCPTZP10212	10# x 2 1/2	500
MSCPTZP103	10# x 3	500

12 #		Qty
MSCPTZP1258	12# x 5/8	1,000
MSCPTZP1234	12# x 3/4	1,000
MSCPTZP121	12# x 1	1,000
MSCPTZP12114	12# x 1 1/4	1,000
MSCPTZP12112	12# x 1 1/2	1,000
MSCPTZP12134	12# x 1 3/4	1,000
MSCPTZP122	12# x 2	1,000
MSCPTZP12212	12# x 2 1/2	500
MSCPTZP123	12# x 3	500

14 #		
MSCPTZP1412	14# x 1/2	1,000
MSCPTZP1458	14# x 5/8	1,000
MSCPTZP1434	14# x 3/4	1,000
MSCPTZP141	14# x 1	1,000
MSCPTZP14114	14# x 1 1/4	1,000
MSCPTZP14112	14# x 1 1/2	1,000
MSCPTZP14134	14# x 1 3/4	1,000
MSCPTZP142	14# x 2	1,000
MSCPTZP14212	14# x 2 1/2	500
MSCPTZP143	14# x 3	500

**Countersunk Head**  
**PHILLIPS**  
**STEEL - IMPERIAL**  
**MECHANICALLY**  
**GALVANISED (15um)**

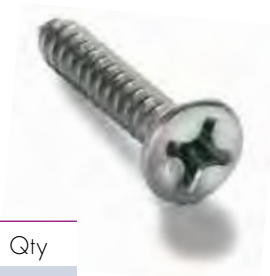

8 #		Qty
MSCPTHP834	8# x 3/4	1,000

## SELF TAPPING SCREWS - Category 8

**Countersunk Head**  
**SQUARE/PHILLIPS**  
**COMBINATION**  
**STEEL - IMPERIAL**  
**ZINC PLATED**



<b>4 #</b>		Qty
MSCCTZP414	4# x 1/4	1,000
MSCCTZP438	4# x 3/8	1,000
MSCCTZP412	4# x 1/2	1,000
MSCCTZP458	4# x 5/8	1,000
MSCCTZP434	4# x 3/4	1,000
MSCCTZP41	4# x 1	1,000

<b>5 #</b>		Qty
MSCCTZP558	5# x 5/8	1,000
MSCCTZP534	5# x 3/4	1,000

<b>6 #</b>		Qty
MSCCTZP638	6# x 3/8	1,000
MSCCTZP612	6# x 1/2	1,000
MSCCTZP658	6# x 5/8	1,000
MSCCTZP634	6# x 3/4	1,000
MSCCTZP61	6# x 1	1,000
MSCCTZP6114	6# x 1 1/4	1,000
MSCCTZP6112	6# x 1 1/2	1,000

<b>8 #</b>		Qty
MSCCTZP838	8# x 3/8	1,000
MSCCTZP812	8# x 1/2	1,000
MSCCTZP858	8# x 5/8	1,000
MSCCTZP834	8# x 3/4	1,000
MSCCTZP81	8# x 1	1,000
MSCCTZP8114	8# x 1 1/4	1,000
MSCCTZP8112	8# x 1 1/2	1,000
MSCCTZP8134	8# x 1 3/4	1,000
MSCCTZP82	8# x 2	1,000

<b>10 #</b>		Qty
MSCCTZP1012	10# x 1/2	1,000
MSCCTZP1058	10# x 5/8	1,000
MSCCTZP1034	10# x 3/4	1,000
MSCCTZP101	10# x 1	1,000
MSCCTZP10114	10# x 1 1/4	1,000
MSCCTZP10112	10# x 1 1/2	1,000
MSCCTZP10134	10# x 1 3/4	1,000
MSCCTZP102	10# x 2	1,000

<b>12 #</b>		Qty
MSCCTZP1258	12# x 5/8	1,000
MSCCTZP1234	12# x 3/4	1,000
MSCCTZP121	12# x 1	1,000
MSCCTZP12114	12# x 1 1/4	1,000
MSCCTZP12112	12# x 1 1/2	1,000
MSCCTZP12134	12# x 1 3/4	1,000
MSCCTZP122	12# x 2	1,000

<b>14 #</b>		Qty
MSCCTZP1412	14# x 1/2	1,000
MSCCTZP1458	14# x 5/8	1,000
MSCCTZP1434	14# x 3/4	1,000
MSCCTZP141	14# x 1	1,000
MSCCTZP14114	14# x 1 1/4	1,000
MSCCTZP14112	14# x 1 1/2	1,000
MSCCTZP142	14# x 2	1,000

## SELF TAPPING SCREWS - Category 8

**Countersunk  
Combination  
SQUARE/PHILLIPS  
Self Tapper Grab Kit  
ASSORTMENT PACK  
ZINC PLATED  
4 to 10 Gauge Diameters**



SELF TAPPER KIT		Qty
STCSKKIT12	12 Sizes	2,400

### SELF TAPPER KIT STCSKKIT12 - CONTENTS AND QUANTITIES

Part Number	Size	Qty. per Kit	Part Number	Size	Qty. per Kit
MSCCTZP438	4# x 3/8	500	MSCCTZP61	6# x 1	100
MSCCTZP412	4# x 1/2	500	MSCCTZP812	8# x 1/2	200
MSCCTZP434	4# x 3/4	200	MSCCTZP834	8# x 3/4	100
MSCCTZP612	6# x 1/2	200	MSCCTZP81	8# x 1	100
MSCCTZP658	6# x 5/8	200	MSCCTZP101	10# x 1	50
MSCCTZP634	6# x 3/4	200	MSCCTZP10112	10# x 1 1/2	50

36

**Pan and Countersunk  
ASSORTMENT PACK  
Self Tapper Grab Kit  
ASSORTMENT PACK  
ZINC PLATED  
4 to 10 Gauge Diameters**



SELF TAPPER KIT		Qty
STKIT24	24 Sizes	4,800

### SELF TAPPER KIT STKIT24 - CONTENTS AND QUANTITIES

Part Number	Size	Qty. per Kit	Part Number	Size	Qty. per Kit
MSPCTZP414	4# x 1/4	500	MSCCTZP438	4# x 3/8	500
MSPCTZP438	4# x 3/8	500	MSCCTZP412	4# x 1/2	500
MSPCTZP638	6# x 3/8	200	MSCCTZP434	4# x 3/4	200
MSPCTZP612	6# x 1/2	200	MSCCTZP612	6# x 1/2	200
MSPCTZP634	6# x 3/4	100	MSCCTZP658	6# x 5/8	200
MSPCTZP61	6# x 1	100	MSCCTZP634	6# x 3/4	200
MSPCTZP838	8# x 3/8	200	MSCCTZP61	6# x 1	100
MSPCTZP812	8# x 1/2	200	MSCCTZP812	8# x 1/2	200
MSPCTZP834	8# x 3/4	100	MSCCTZP834	8# x 3/4	100
MSPCTZP81	8# x 1	100	MSCCTZP81	8# x 1	100
MSPCTZP1012	10# x 1/2	100	MSCCTZP101	10# x 1	50
MSPCTZP1034	10# x 3/4	100	MSCCTZP10112	10# x 1 1/2	50



## SELF TAPPING SCREWS - Category 8

### Pan Head PHILLIPS STEEL - IMPERIAL BLACK ZINC PLATED



4 #		Qty
MSPPTBZP438	4# x 3/8	1,000
MSPPTBZP412	4# x 1/2	1,000
6 #		
MSPPTBZP638	6# x 3/8	1,000
MSPPTBZP612	6# x 1/2	1,000
MSPPTBZP658	6# x 5/8	1,000
MSPPTBZP634	6# x 3/4	1,000
MSPPTBZP61	6# x 1	1,000
MSPPTBZP6114	6# x 1 1/4	1,000
MSPPTBZP6112	6# x 1 1/2	1,000

8 #		Qty
MSPPTBZP838	8# x 3/8	1,000
MSPPTBZP812	8# x 1/2	1,000
MSPPTBZP858	8# x 5/8	1,000
MSPPTBZP834	8# x 3/4	1,000
MSPPTBZP81	8# x 1	1,000
MSPPTBZP8114	8# x 1 1/4	1,000
MSPPTBZP8112	8# x 1 1/2	1,000
10 #		
MSPPTBZP1034	10# x 3/4	1,000
MSPPTBZP101	10# x 1	1,000
MSPPTBZP10114	10# x 1 1/4	1,000

### Countersunk Head PHILLIPS STEEL - IMPERIAL BLACK ZINC PLATED



4 #		Qty
MSCPTBZP438	4# x 3/8	1,000
MSCPTBZP412	4# x 1/2	1,000
6 #		
MSCPTBZP638	6# x 3/8	1,000
MSCPTBZP612	6# x 1/2	1,000
MSCPTBZP658	6# x 5/8	1,000
MSCPTBZP634	6# x 3/4	1,000

8 #		Qty
MSCPTBZP812	8# x 1/2	1,000
MSCPTBZP858	8# x 5/8	1,000
MSCPTBZP834	8# x 3/4	1,000
MSCPTBZP81	8# x 1	1,000
MSCPTBZP8114	8# x 1 1/4	1,000
MSCPTBZP8112	8# x 1 1/2	1,000
10 #		Qty
MSCPTBZP1034	10# x 3/4	1,000
MSCPTBZP101	10# x 1	1,000
MSCPTBZP10114	10# x 1 1/4	1,000

### Flange Head PHILLIPS STEEL - IMPERIAL BLACK ZINC PLATED AUTOMOTIVE SCREW



6 #		Qty
MSFPBZP638	6# x 3/8	1,000
MSFPBZP612	6# x 1/2	1,000
MSFPBZP634	6# x 3/4	1,000
8 #		
MSFPBZP838	8# x 3/8	1,000
MSFPBZP812	8# x 1/2	1,000
MSFPBZP834	8# x 3/4	1,000
MSFPBZP81	8# x 1	1,000
MSFPBZP8112	8# x 1 1/2	1,000

10 #		Qty
MSFPBZP1012	10# x 1/2	1,000
MSFPBZP1034	10# x 3/4	1,000
MSFPBZP101	10# x 1	1,000
MSFPBZP10112	10# x 1 1/2	1,000
MSFPBZP102	10# x 2	1,000



## SELF TAPPING SCREWS - Category 8

**Flange Head**  
**PHILLIPS**  
**Automotive Self**  
**Tapper Grab Kit**  
**ASSORTMENT PACK**  
**BLACK ZINC PLATED**

### SELF TAPPER KIT

FPKIT12

12 Sizes

Qty

1,225



### SELF TAPPER KIT FPKIT12 - CONTENTS AND QUANTITIES

Part Number	Size	Qty. per Kit	Part Number	Size	Qty. per Kit
MSFPBZP638	6# x 3/8	200	MSFPBZP81	8# x 1	50
MSFPBZP612	6# x 1/2	200	MSFPBZP812	8# x 1 1/2	50
MSFPBZP634	6# x 3/4	100	MSFPBZP1012	10# x 1/2	100
MSFPBZP838	8# x 3/8	200	MSFPBZP1034	10# x 3/4	50
MSFPBZP812	8# x 1/2	100	MSFPBZP101	10# x 1	50
MSFPBZP834	8# x 3/4	100	MSFPBZP1012	10# x 2	25

# NUTS

## Metric, Imperial, Unified & B.A

### Category 9

#### Cold Formed Hexagon – Metric, Imperial, Unified & B.A Steel Zinc & Brass



40

#### Square Pressed Nuts Steel Zinc



42

#### Dome Nuts Chrome & Galvanised



43

#### Wing Nuts Steel Zinc, Brass & Galvanised



44

#### Flange Nuts Steel Zinc Clear



45

#### Tee Nuts - 4 Prong Steel Zinc



45

#### Specifications:

Metric Hex Standard Nut:	AS 1112
Imperial Hex Standard Nut:	1/8-3/16 AS B50
Imperial Hex Standard Nut:	1/4-1/2 AS 2451
Unified:	ANSI B 18.6.3
B.A:	BS 57
Pressed Nuts:	Metric - Refer Chart on page 39
Pressed Nuts:	Imperial - Refer Chart on page 39
Dome Nuts:	Metric DIN 1587
Dome Nuts:	Imperial ANSI Standard
Wing Nuts:	Metric UNI 5448
Wing Nuts:	Imperial ANSI B 18.17
Flange Nuts:	Metric DIN 6923

## NUTS - Category 9

### Hexagonal Nut COLD FORMED STEEL - METRIC ZINC PLATED



<b>M 1.6</b>		Qty
MSHNZB16	<b>M1.6</b>	10,000
MSHNZP16	<b>M1.6</b>	200

<b>M 2</b>		Qty
MSHNZB2	<b>M2</b>	10,000
MSHNZP2	<b>M2</b>	200

<b>M 2.5</b>		Qty
MSHNZB25	<b>M2.5</b>	10,000
MSHNZP25	<b>M2.5</b>	200

<b>M 3</b>		Qty
MSHNZB3	<b>M3</b>	10,000
MSHNZP3	<b>M3</b>	200

<b>M 3.5</b>		Qty
MSHNZB35	<b>M3.5</b>	10,000
MSHNZP35	<b>M3.5</b>	200

<b>M 4</b>		Qty
MSHNZB4	<b>M4</b>	10,000
MSHNZP4	<b>M4</b>	200

<b>M 5</b>		Qty
MSHNZB5	<b>M5</b>	9,000
MSHNZP5	<b>M5</b>	200

<b>M 6</b>		Qty
MSHNZB6	<b>M6</b>	5,000
MSHNZP6	<b>M6</b>	200

<b>M 8</b>		Qty
MSHNZB8	<b>M8</b>	3,000
MSHNZP8	<b>M8</b>	200

<b>M 10</b>		Qty
MSHNZB10	<b>M10</b>	2,000
MSHNZP10	<b>M10</b>	200

40

### Hexagonal Nut COLD FORMED STEEL - METRIC BLACK ZINC PLATED



<b>M 3</b>		Qty
MSHNBZP3	<b>M3</b>	200

<b>M 4</b>		Qty
MSHNBZP4	<b>M4</b>	200

<b>M 5</b>		Qty
MSHNBZP5	<b>M5</b>	200

<b>M 6</b>		Qty
MSHNBZP6	<b>M6</b>	200

### Hexagonal Nut COLD FORMED STEEL BSW - IMPERIAL ZINC PLATED



<b>1/8</b>		Qty
MSHNZB18	<b>1/8</b>	10,000
MSHNZP18	<b>1/8</b>	200

<b>5/32</b>		Qty
MSHNZB532	<b>5/32</b>	10,000
MSHNZP532	<b>5/32</b>	200

<b>3/16</b>		Qty
MSHNZB316	<b>3/16</b>	10,000
MSHNZP316	<b>3/16</b>	200

<b>1/4</b>		Qty
MSHNZB14	<b>1/4</b>	6,000
MSHNZP14	<b>1/4</b>	200

<b>5/16</b>		Qty
MSHNZB516	<b>5/16</b>	4,000
MSHNZP516	<b>5/16</b>	200

<b>3/8</b>		Qty
MSHNZB38	<b>3/8</b>	2,500
MSHNZP38	<b>3/8</b>	200

## NUTS - Category 9

### Hexagonal Nut COLD FORMED STEEL - UNIFIED ZINC PLATED



<b>2-56</b>		Qty
MSHNZB256	2-56 UNC	1,000
MSHNZP256	2-56 UNC	200
<b>4-40</b>		
MSHNZB440	4-40 UNC	1,000
MSHNZP440	4-40 UNC	200

<b>6-32</b>		Qty
MSHNZB632	6-32 UNC	1,000
MSHNZP632	6-32 UNC	200
<b>8-32</b>		
MSHNZB832	8-32 UNC	1,000
MSHNZP832	8-32 UNC	200

<b>10-32</b>		Qty
MSHNZB1032	10-32 UNF	1,000
MSHNZP1032	10-32 UNF	200

### Hexagonal Nut COLD FORMED STEEL - B.A ZINC PLATED



<b>6BA</b>		Qty
MSHNZB6BA	6BA	1,000
MSHNZP6BA	6BA	200
<b>4BA</b>		
MSHNZB4BA	4BA	1,000
MSHNZP4BA	4BA	200

<b>2BA</b>		Qty
MSHNZB2BA	2BA	1,000
MSHNZP2BA	2BA	200

### Hexagonal Nut COLD FORMED BRASS - METRIC



<b>M 2.5</b>		Qty
BRHNB25	M2.5	1,000
BRHNP25	M2.5	200
<b>M 3</b>		
BRHNB3	M3	1,000
BRHNP3	M3	200
<b>M 4</b>		
BRHNB4	M4	1,000
BRHNP4	M4	200

<b>M 5</b>		Qty
BRHNB5	M5	1,000
BRHNP5	M5	200
<b>M 6</b>		
BRHNB6	M6	1,000
BRHNP6	M6	200

<b>M 8</b>		Qty
BRHNP8	M8	50
<b>M 10</b>		
BRHNP10	M10	50
<b>M 12</b>		
BRHNP12M	M12	50

## NUTS - Category 9

### Hexagonal Nut COLD FORMED BRASS - BSW IMPERIAL



<b>1/8</b>		Qty
BRHNB18	1/8	1,000
BRHNP18	1/8	200
<b>5/32</b>		
BRHNB532	5/32	1,000
BRHNP532	5/32	200

<b>3/16</b>		Qty
BRHNB316	3/16	1,000
BRHNP316	3/16	200
<b>1/4</b>		
BRHNB14	1/4	1,000
BRHNP14	1/4	200

<b>5/16</b>		Qty
BRHNP516	5/16	50
<b>3/8</b>		
BRHNP38	3/8	50

### Hexagonal Nut COLD FORMED BRASS - UNIFIED

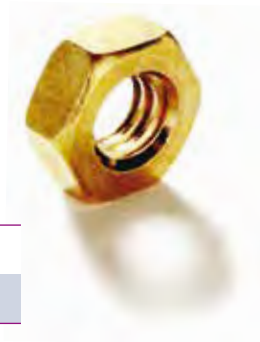

<b>1/2</b>		Qty
BRHNC12	1/2 UNC	50

### Hexagonal Nut COLD FORMED BRASS - B.A



<b>6BA</b>		Qty
BRHNB6BA	6BA	1,000
BRHNP6BA	6BA	200

<b>4BA</b>		Qty
BRHNB4BA	4BA	1,000
BRHNP4BA	4BA	200

<b>2BA</b>		Qty
BRHNB2BA	2BA	1,000
BRHNP2BA	2BA	200

### Square PRESSED NUT STEEL - METRIC ZINC PLATED



<b>M 3</b>		Qty
MSSPNZB3	M3	1,000
MSSPNZP3	M3	200
<b>M 4</b>		
MSSPNZB4	M4	1,000
MSSPNZP4	M4	200

<b>M 5</b>		Qty
MSSPNZB5	M5	1,000
MSSPNZP5	M5	200
<b>M 6</b>		
MSSPNZB6	M6	1,000
MSSPNZP6	M6	200

#### Square Pressed Nut Dimension Table

Diameter	A/F		Thick (Max)
	Maximum	Minimum	
M3	5.5	5.32	1.8
M4	7.0	6.78	2.2
M5	8.0	7.78	2.7
M6	10.0	9.78	3.2

Measurements above are in millimeters.

Next page for Imperial Pressed Nuts

## NUTS - Category 9

### Square PRESSED NUT STEEL BSW - IMPERIAL ZINC PLATED



<b>1/8</b>		Qty
MSSPNZB18	1/8	1,000
MSSPNZP18	1/8	200

<b>5/32</b>		Qty
MSSPNZB532	5/32	1,000
MSSPNZP532	5/32	200

<b>3/16</b>		Qty
MSSPNZB316	3/16	1,000
MSSPNZP316	3/16	200

<b>1/4</b>		Qty
MSSPNZB14	1/4	1,000
MSSPNZP14	1/4	200

<b>5/16</b>		Qty
MSSPNZB516	5/16	1,000
MSSPNZP516	5/16	200

#### Square Pressed Nut Dimension Table

Diameter	Maximum	A/F Minimum	Thick (Max)
1/8	5.58	5.28	2.12
5/32	7.15	6.79	2.73
3/16	8.20	7.83	3.00
1/4	11.0	10.57	3.00
5/16	14.20	13.80	5.60

Measurements above are in millimeters.

### Dome Nut MILD STEEL METRIC CHROME PLATED



<b>M 3</b>		Qty
MSDNCP3	M3 (5.5 A/F)	200

<b>M 4</b>		Qty
MSDNCP4	M4 (7.0 A/F)	200

<b>M 5</b>		Qty
MSDNCP5	M5 (8.0 A/F)	200

<b>M 6</b>		Qty
MSDNCP6	M6 (10.0 A/F)	200

<b>M 8</b>		Qty
MSDNCP8	M8 (13.0 A/F)	200

<b>M 10</b>		Qty
MSDNCP10	M10 (17.0 A/F)	100

<b>M 12</b>		Qty
MSDNCP12M	M12 (19.0 A/F)	100

<b>M 16</b>		Qty
MSDNCP16	M16 (24.0 A/F)	25

<b>M 20</b>		Qty
MSDNCP20	M20 (30.0 A/F)	25

<b>M 24</b>		Qty
MSDNCP24	M24 (36.0 A/F)	20

### Dome Nut MILD STEEL IMPERIAL CHROME PLATED



<b>5/32</b>		Qty
MSDNCP532	5/32 (5/16 A/F)	200

<b>3/16</b>		Qty
MSDNCP316	3/16 (3/8 A/F)	200

<b>1/4</b>		Qty
MSDNCP14	1/4 (7/16 A/F)	200

<b>5/16</b>		Qty
MSDNCP516	5/16 (9/16 A/F)	200

<b>3/8</b>		Qty
MSDNCP38	3/8 (5/8 A/F)	100

<b>1/2 BSW</b>		Qty
MSDNCP12	1/2BSW (3/4 A/F)	100

### Dome Nut MILD STEEL Thread Tapped Oversize METRIC HOT DIPPED GALVANISED



<b>M 8</b>		Qty
MSDNCP8	M8 (13.0 A/F)	200

<b>M 10</b>		Qty
MSDNCP10	M10 (17.0 A/F)	100

<b>M 12</b>		Qty
MSDNCP12M	M12 (19.0 A/F)	100

<b>M 16</b>		Qty
MSDNCP16	M16 (24.0 A/F)	25

<b>M 20</b>		Qty
MSDNCP20	M20 (30.0 A/F)	25

<b>M 24</b>		Qty
MSDNCP24	M24 (36.0 A/F)	20

<b>M 30</b>		Qty
MSDNCP30	M30 (46.0 A/F)	10

<b>M 36</b>		Qty
MSDNCP36	M36 (55.0 A/F)	5



## NUTS - Category 9

### Wing Nut COLD FORMED STEEL METRIC ZINC PLATED



M 3		Qty
MSWNZB3	M3	1,000
MSWNZP3	M3	200

M 4		Qty
MSWNZB4	M4	1,000
MSWNZP4	M4	200

M 5		Qty
MSWNZB5	M5	1,000
MSWNZP5	M5	200

M 6		Qty
MSWNZB6	M6	1,000
MSWNZP6	M6	200

M 8		Qty
MSWNZB8	M8	1,000
MSWNZP8	M8	200

M 10		Qty
MSWNZP10	M10	200

M 12		Qty
MSWNZP12M	M12	200

M 16		Qty
MSWNZP16	M16	25

M 20		Qty
MSWNZP20	M20	25

### Wing Nut COLD FORMED STEEL IMPERIAL ZINC PLATED



1/8		Qty
MSWNZB18	1/8	1,000
MSWNZP18	1/8	200

5/32		Qty
MSWNZB532	5/32	1,000
MSWNZP532	5/32	200

3/16		Qty
MSWNZB316	3/16	1,000
MSWNZP316	3/16	200

1/4		Qty
MSWNZB14	1/4	1,000
MSWNZP14	1/4	200

5/16		Qty
MSWNZB516	5/16	1,000
MSWNZP516	5/16	200

3/8		Qty
MSWNZP38	3/8	200

1/2 BSW		Qty
MSWNZP12	1/2	200

### Wing Nut MILD STEEL METRIC MECHANICALLY GALVANISED 15um



M 8		Qty
MSWNHP8	M8	200

M 10		Qty
MSWNHP10	M10	100

M 12		Qty
MSWNHP12M	M12	100

M 16		Qty
MSWNHP16	M16	25

### Wing Nut BRASS METRIC



M 3		Qty
BRWNB3	M3	1,000
BRWNP3	M3	200

M 4		Qty
BRWNB4	M4	1,000
BRWNP4	M4	200

M 5		Qty
BRWNB5	M5	1,000
BRWNP5	M5	200

M 6		Qty
BRWNB6	M6	1,000
BRWNP6	M6	200

M 8		Qty
BRWNB8	M8	1,000
BRWNP8	M8	200

M 10		Qty
BRWNP10	M10	100

M 12		Qty
BRWNP12M	M12	50

## NUTS - Category 9

### Wing Nut BRASS IMPERIAL



<b>1/8</b>		Qty
BRWNB18	1/8	1,000
BRWNP18	1/8	200
<b>5/32</b>		
BRWNB532	5/32	1,000
BRWNP532	5/32	200

<b>3/16</b>		
BRWNB316	3/16	1,000
BRWNP316	3/16	200
<b>1/4</b>		Qty
BRWNB14	1/4	1,000
BRWNP14	1/4	200

<b>5/16</b>		
BRWNB516	5/16	1,000
BRWNP516	5/16	200
<b>3/8</b>		Qty
BRWNP38	3/8	100
<b>1/2 BSW</b>		
BRWNP12	1/2	50

### Flanged NUT Hexagon Serrated METRIC ZINC CLEAR PLATED



<b>M 3</b>		Qty
MSFNZP3	M3	200
<b>M 4</b>		
MSFNZP4	M4	200

<b>M 5</b>		Qty
MSFNZP5	M5	200
<b>M 6</b>		
MSFNZP6	M6	200

<b>M 8</b>		Qty
MSFNZP8	M8	200
<b>M 10</b>		
MSFNZP10	M10	200

### Tee Nuts - 4 Prong MILD STEEL METRIC For Wood ZINC PLATED



<b>M 4</b>		Qty
MSTNZP4	M4 x 15 x 7	200
<b>M 5</b>		
MSTNZP5	M5 x 15 x 7	200

<b>M 6</b>		Qty
MSTNZP6	M6 x 18 x 7	200
<b>M 8</b>		
MSTNZP89	M8 x 22 x 9	200
MSTNZP816	M8 x 22 x 16	200

<b>M 10</b>		Qty
MSTNZP10	M10 x 25 x 11	200

### Tee Nuts - 4 Prong MILD STEEL IMPERIAL For Wood ZINC PLATED



<b>3/16</b>		Qty
MSTNZP316	3/16unc 18 x 7mm	200
<b>1/4</b>		
MSTNZP14	1/4unc 18 x 7mm	200

<b>5/16</b>		Qty
MSTNZP5169	5/16unc 22 x 9mm	200
MSTNZP51616	5/16unc 22 x 16mm	200

<b>3/8</b>		Qty
MSTNZP38	3/8unc 25 x 11mm	200

# THUMB & WING SCREWS

Steel Zinc Plated

Category 10

Thumb Screw



47

Wing Screw



48

***Plating / Material:***

Zinc Clear

Stainless Steel

***Specifications:***

Thumb Screws: Refer Drawing

Wing Screws: Refer Drawing

## THUMB & WING SCREWS - Category 10

### Thumb Screw STEEL - METRIC ZINC PLATED



<b>M 5</b>		Qty
MSTSzb512	5 x 12	1,000
MSTSzP512	5 x 12	200
MSTSzb516	5 x 16	1,000
MSTSzP516	5 x 16	200
MSTSzb520	5 x 20	1,000
MSTSzP520	5 x 20	200
MSTSzb525	5 x 25	1,000
MSTSzP525	5 x 25	200

<b>M 6</b>		Qty
MSTSzb612	6 x 12	1,000
MSTSzP612	6 x 12	200
MSTSzb616	6 x 16	1,000
MSTSzP616	6 x 16	200
MSTSzb620	6 x 20	1,000
MSTSzP620	6 x 20	200
MSTSzb625	6 x 25	1,000
MSTSzP625	6 x 25	200
MSTSzb640	6 x 40	1,000
MSTSzP640	6 x 40	200

<b>M 8</b>		Qty
MSTSzb820	8 x 20	1,000
MSTSzP820	8 x 20	200
MSTSzb825	8 x 25	1,000
MSTSzP825	8 x 25	200
MSTSzb830	8 x 30	1,000
MSTSzP830	8 x 30	200
MSTSzb840	8 x 40	1,000
MSTSzP840	8 x 40	200
MSTSzb850	8 x 50	1,000
MSTSzP850	8 x 50	200

### Thumb Screw STEEL - IMPERIAL ZINC PLATED



<b>3/16</b>		Qty
MSTSzb31612	3/16 x 1/2	1,000
MSTSzP31612	3/16 x 1/2	200
MSTSzb31634	3/16 x 3/4	1,000
MSTSzP31634	3/16 x 3/4	200
MSTSzb3161	3/16 x 1	1,000
MSTSzP3161	3/16 x 1	200

<b>1/4</b>		Qty
MSTSzb1412	1/4 x 1/2	1,000
MSTSzP1412	1/4 x 1/2	200
MSTSzb1434	1/4 x 3/4	1,000
MSTSzP1434	1/4 x 3/4	200
MSTSzb141	1/4 x 1	1,000
MSTSzP141	1/4 x 1	200
MSTSzb14114	1/4 x 1 1/4	1,000
MSTSzP14114	1/4 x 1 1/4	200
MSTSzb14112	1/4 x 1 1/2	1,000
MSTSzP14112	1/4 x 1 1/2	200

<b>5/16</b>		Qty
MSTSzb51634	5/16 x 3/4	1,000
MSTSzP51634	5/16 x 3/4	200
MSTSzb5161	5/16 x 1	1,000
MSTSzP5161	5/16 x 1	200
MSTSzb516114	5/16 x 1 1/4	1,000
MSTSzP516114	5/16 x 1 1/4	200
MSTSzb516112	5/16 x 1 1/2	1,000
MSTSzP516112	5/16 x 1 1/2	200

### Thumb Screw Stainless Steel Grade 304 - METRIC

<b>M 6</b>		Qty
S4TSP620	6 x 20	50



### Thumb Screw Stainless Steel Grade 304 - IMPERIAL

<b>5/16</b>		Qty
S4TSP5161	5/16 x 1 UNC	50

## THUMB & WING SCREWS - Category 10

### Wing Screw STEEL - METRIC ZINC PLATED



<b>M 3</b>		Qty
MSWSZP310	M3 x 10	200
MSWSZP312	M3 x 12	200
MSWSZP315	M3 x 15	200

<b>M 4</b>		Qty
MSWSZP410	M4 x 10	200
MSWSZP412	M4 x 12	200
MSWSZP415	M4 x 15	200
MSWSZP420	M4 x 20	200

<b>M 5</b>		Qty
MSWSZP510	M5 x 10	200
MSWSZP512	M5 x 12	200
MSWSZP515	M5 x 15	200
MSWSZP520	M5 x 20	200
MSWSZP525	M5 x 25	200

<b>M 6</b>		Qty
MSWSZP610	M6 x 10	200
MSWSZP612	M6 x 12	200
MSWSZP615	M6 x 15	200
MSWSZP620	M6 x 20	200
MSWSZP625	M6 x 25	200
MSWSZP630	M6 x 30	200
MSWSZP640	M6 x 40	200

<b>M 8</b>		Qty
MSWSZP815	M8 x 15	100
MSWSZP820	M8 x 20	100
MSWSZP825	M8 x 25	100
MSWSZP830	M8 x 30	100
MSWSZP840	M8 x 40	100
MSWSZP850	M8 x 50	50

<b>M 10</b>		Qty
MSWSZP1020	M10 x 20	50
MSWSZP1025	M10 x 25	50
MSWSZP1030	M10 x 30	50
MSWSZP1040	M10 x 40	50
MSWSZP1050	M10 x 50	25

<b>M 12</b>		Qty
MSWSZP1220	M12 x 20	20
MSWSZP1225	M12 x 25	20
MSWSZP1230	M12 x 30	20
MSWSZP1240	M12 x 40	20
MSWSZP1250	M12 x 50	20

48

### Wing Screw Stainless Steel Grade 304 - METRIC



<b>M 5</b>		Qty
S4WSP516	M5 x 16	50
S4WSP520	M5 x 20	50
S4WSP525	M5 x 25	50

<b>M 6</b>		Qty
S4WSP612	M6 x 12	50
S4WSP616	M6 x 16	50
S4WSP620	M6 x 20	50
S4WSP625	M6 x 25	50
S4WSP630	M6 x 30	50

<b>M 8</b>		Qty
S4WSP820	M8 x 20	25
S4WSP825	M8 x 25	25
S4WSP830	M8 x 30	25

<b>M 10</b>		Qty
S4WSP1025	M10 x 25	20
S4WSP1030	M10 x 30	20
S4WSP1040	M10 x 40	20
S4WSP1050	M10 x 50	20

<b>M 12</b>		Qty
S4WSP1225	M12 x 25	10
S4WSP1230	M12 x 30	10
S4WSP1240	M12 x 40	10
S4WSP1250	M12 x 50	10

Split Pins



50

R-Clips



53

Hi-Spring Clip



56

Double Coil R-Clip



56

Hair Pin Clips



56

Linch Pins



57

Shaft Locking Pins



58 59

Clevis Pins



62

Retail Stands



54 60 61

Assortment Kits



52 55 56 57 62

Plating / Material:

Zinc Plated & Zinc Yellow Plated  
Stainless Steel

Specifications:

Split Pins:	DIN 94
R-Clips:	Refer Drawing
Double Coil R-Clip:	DIN 11024
Hair Pin:	Refer Drawing
Linch Pin:	Refer Drawing
Shaft Locking:	Refer Drawing
Clevis Pins:	ASME B18.8.1



# PINS & CLIPS - Category II

**SPLIT PIN**  
**STEEL - METRIC**  
**ZINC PLATED**

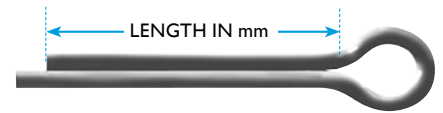

<b>M 1.6</b>		Qty
MSSPZP1610	1.6 x 10	200
MSSPZP1612	1.6 x 12	200
MSSPZP1616	1.6 x 16	200
MSSPZP1620	1.6 x 20	200
MSSPZP1622	1.6 x 22	200
MSSPZP1625	1.6 x 25	200
MSSPZP1628	1.6 x 28	200
MSSPZP1632	1.6 x 32	200
MSSPZP1636	1.6 x 36	200
MSSPZP1640	1.6 x 40	200
MSSPZP1650	1.6 x 50	200

<b>M 2</b>		Qty
MSSPZP212	2 x 12	200
MSSPZP216	2 x 16	200
MSSPZP220	2 x 20	200
MSSPZP222	2 x 22	200
MSSPZP225	2 x 25	200
MSSPZP228	2 x 28	200
MSSPZP232	2 x 32	200
MSSPZP236	2 x 36	200
MSSPZP240	2 x 40	200
MSSPZP250	2 x 50	200

<b>M 2.5</b>		Qty
MSSPZP2512	2.5 x 12	200
MSSPZP2516	2.5 x 16	200
MSSPZP2520	2.5 x 20	200
MSSPZP2522	2.5 x 22	200
MSSPZP2525	2.5 x 25	200
MSSPZP2528	2.5 x 28	200
MSSPZP2532	2.5 x 32	200
MSSPZP2536	2.5 x 36	200
MSSPZP2540	2.5 x 40	200
MSSPZP2545	2.5 x 45	200
MSSPZP2550	2.5 x 50	200
MSSPZP2556	2.5 x 56	200
MSSPZP2563	2.5 x 63	200

<b>M 3.2</b>		Qty
MSSPZP3212	3.2 x 12	200
MSSPZP3216	3.2 x 16	200
MSSPZP3220	3.2 x 20	200
MSSPZP3225	3.2 x 25	200

<b>M 3.2</b> Continued		Qty
MSSPZP3232	3.2 x 32	200
MSSPZP3236	3.2 x 36	200
MSSPZP3240	3.2 x 40	200
MSSPZP3245	3.2 x 45	200
MSSPZP3250	3.2 x 50	200
MSSPZP3256	3.2 x 56	200
MSSPZP3263	3.2 x 63	200
MSSPZP3271	3.2 x 71	200
MSSPZP3280	3.2 x 80	200

<b>M 4</b>		Qty
MSSPZP420	4 x 20	200
MSSPZP425	4 x 25	200
MSSPZP428	4 x 28	200
MSSPZP432	4 x 32	200
MSSPZP436	4 x 36	200
MSSPZP440	4 x 40	200
MSSPZP445	4 x 45	200
MSSPZP450	4 x 50	200
MSSPZP456	4 x 56	200
MSSPZP463	4 x 63	200
MSSPZP471	4 x 71	200
MSSPZP480	4 x 80	200
MSSPZP490	4 x 90	200
MSSPZP4100	4 x 100	200

<b>M 5</b>		Qty
MSSPZP520	5 x 20	200
MSSPZP525	5 x 25	200
MSSPZP528	5 x 28	200
MSSPZP532	5 x 32	200
MSSPZP536	5 x 36	200
MSSPZP540	5 x 40	200
MSSPZP545	5 x 45	200
MSSPZP550	5 x 50	200
MSSPZP556	5 x 56	200
MSSPZP563	5 x 63	200
MSSPZP571	5 x 71	200
MSSPZP580	5 x 80	200
MSSPZP590	5 x 90	200
MSSPZP5100	5 x 100	200
MSSPZP5125	5 x 125	200

<b>M 6.3</b>		Qty
MSSPZP6325	6.3 x 25	200
MSSPZP6332	6.3 x 32	200
MSSPZP6336	6.3 x 36	200
MSSPZP6340	6.3 x 40	200
MSSPZP6345	6.3 x 45	200
MSSPZP6350	6.3 x 50	200
MSSPZP6356	6.3 x 56	200
MSSPZP6363	6.3 x 63	200
MSSPZP6371	6.3 x 71	200
MSSPZP6380	6.3 x 80	200
MSSPZP6390	6.3 x 90	200
MSSPZP63100	6.3 x 100	200
MSSPZP63125	6.3 x 125	200
MSSPZP63150	6.3 x 150	100

<b>M 8</b>		Qty
MSSPZP850	8 x 50	100
MSSPZP856	8 x 56	100
MSSPZP863	8 x 63	100
MSSPZP871	8 x 71	100
MSSPZP880	8 x 80	100
MSSPZP890	8 x 90	100
MSSPZP8100	8 x 100	100
MSSPZP8125	8 x 125	100
MSSPZP8150	8 x 150	100

<b>M 10</b>		Qty
MSSPZP1050	10 x 50	100
MSSPZP1063	10 x 63	100
MSSPZP1071	10 x 71	100
MSSPZP1080	10 x 80	100
MSSPZP1090	10 x 90	100
MSSPZP10100	10 x 100	100
MSSPZP10125	10 x 125	100
MSSPZP10150	10 x 150	50

<b>M 13</b>		Qty
MSSPZP1350	13 x 50	50
MSSPZP1363	13 x 63	50
MSSPZP1380	13 x 80	50
MSSPZP13100	13 x 100	50
MSSPZP13125	13 x 125	50
MSSPZP13150	13 x 150	50

## PINS & CLIPS - Category II

### SPLIT PIN METRIC STAINLESS STEEL Grade G304

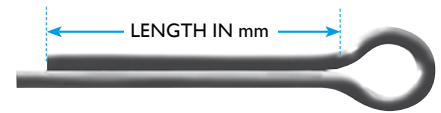

<b>M 1.6</b>		Qty
S4SPP1610	1.6 x 10	200
S4SPP1612	1.6 x 12	200
S4SPP1616	1.6 x 16	200
S4SPP1620	1.6 x 20	200
S4SPP1625	1.6 x 25	200
S4SPP1632	1.6 x 32	200
S4SPP1640	1.6 x 40	200

<b>M 2</b>		Qty
S4SPP210	2 x 10	200
S4SPP212	2 x 12	200
S4SPP216	2 x 16	200
S4SPP220	2 x 20	200
S4SPP225	2 x 25	200
S4SPP232	2 x 32	200
S4SPP240	2 x 40	200

<b>M 2.5</b>		Qty
S4SPP2512	2.5 x 12	200
S4SPP2516	2.5 x 16	200
S4SPP2520	2.5 x 20	200
S4SPP2525	2.5 x 25	200
S4SPP2532	2.5 x 32	200
S4SPP2536	2.5 x 36	200
S4SPP2540	2.5 x 40	200
S4SPP2550	2.5 x 50	200

<b>M 3.2</b>		Qty
S4SPP3212	3.2 x 12	200
S4SPP3216	3.2 x 16	200
S4SPP3220	3.2 x 20	200
S4SPP3225	3.2 x 25	200
S4SPP3232	3.2 x 32	200
S4SPP3236	3.2 x 36	200
S4SPP3240	3.2 x 40	200
S4SPP3245	3.2 x 45	200
S4SPP3250	3.2 x 50	200
S4SPP3263	3.2 x 63	200
S4SPP3280	3.2 x 80	200

<b>M 4</b>		Qty
S4SPP420	4 x 20	100
S4SPP425	4 x 25	100
S4SPP432	4 x 32	100
S4SPP436	4 x 36	100
S4SPP440	4 x 40	100
S4SPP445	4 x 45	100
S4SPP450	4 x 50	100
S4SPP463	4 x 63	100

<b>M 5</b>		Qty
S4SPP520	5 x 20	100
S4SPP525	5 x 25	100
S4SPP532	5 x 32	100
S4SPP536	5 x 36	100
S4SPP540	5 x 40	100
S4SPP545	5 x 45	100
S4SPP550	5 x 50	100
S4SPP563	5 x 63	100
S4SPP571	5 x 71	100
S4SPP580	5 x 80	100
S4SPP590	5 x 90	100
S4SPP5100	5 x 100	100

<b>M 6.3</b>		Qty
S4SPP6325	6.3 x 25	100
S4SPP6332	6.3 x 32	100
S4SPP6340	6.3 x 40	100
S4SPP6345	6.3 x 45	100
S4SPP6350	6.3 x 50	100
S4SPP6363	6.3 x 63	100
S4SPP6380	6.3 x 80	100
S4SPP63100	6.3 x 100	100

<b>M 8</b>		Qty
S4SPP850	8 x 50	50
S4SPP863	8 x 63	50
S4SPP880	8 x 80	50
S4SPP890	8 x 90	50
S4SPP8100	8 x 100	50

<b>M 10</b>		Qty
S4SPP1050	10 x 50	50
S4SPP1063	10 x 63	50
S4SPP1080	10 x 80	50
S4SPP1090	10 x 90	50
S4SPP10100	10 x 100	50
S4SPP10125	10 x 125	50
S4SPP10150	10 x 150	50

## PINS & CLIPS - Category II

### SPLIT PIN STEEL ASSORTMENT PACK ZINC PLATED

#### SPLIT PIN PACK

SPKIT20 Mixed Sizes Qty 1,570

#### SPKIT20 CONTENTS AND QUANTITY

Part Number	Size	Qty. per Kit
MSSPZP1636	1.6 x 36	200
MSSPZP225	2 x 25	200
MSSPZP2525	2.5 x 25	200
MSSPZP2532	2.5 x 32	200
MSSPZP3220	3.2 x 20	100
MSSPZP3225	3.2 x 25	100
MSSPZP3232	3.2 x 32	100
MSSPZP3240	3.2 x 40	50
MSSPZP3250	3.2 x 50	50

Part Number	Size	Qty. per Kit
MSSPZP425	4 x 25	50
MSSPZP432	4 x 32	50
MSSPZP440	4 x 40	50
MSSPZP450	4 x 50	50
MSSPZP436	4 x 63	25
MSSPZP540	5 x 40	25
MSSPZP550	5 x 50	25
MSSPZP563	5 x 63	25
MSSPZP6350	6.3 x 50	25
MSSPZP6363	6.3 x 63	25
MSSPZP836	8 x 63	20

### SPLIT PIN STEEL ASSORTMENT PACK STAINLESS STEEL Grade G304

#### STAINLESS STEEL PIN KIT

304SPKIT12 Mixed Sizes Qty 625

Split Pin KIT - Assortment Pack  
12 Sizes - 625 individual pieces -  
2.0mm-6.3mm Diameters

#### 304SPKIT12 CONTENTS AND QTY.

Part Number	Size	Qty. per Kit
S4SPP225	2 x 25	100
S4SPP2532	2.5 x 32	100
S4SPP3225	3.2 x 25	50
S4SPP3232	3.2 x 32	50
S4SPP3240	3.2 x 40	50
S4SPP3250	3.2 x 50	50
S4SPP425	4 x 25	50
S4SPP432	4 x 32	50
S4SPP450	4 x 50	50
S4SPP540	5 x 40	25
S4SPP563	5 x 63	25
S4SPP6363	6.3 x 63	25



## PINS & CLIPS - Category II

### R-CLIP

#### Humpback Pins

#### STEEL - METRIC

#### Standard Packaging

#### ZINC PLATED



<b>M 1.2</b>			Qty
MSHPZP12	1.2 x 15	200	

<b>M 1.6</b>			Qty
MSHPZP16	1.6 x 33	200	

<b>M 2</b>			Qty
MSHPZP2	2.0 x 40	200	

<b>M 2.4</b>			Qty
MSHPZP24	2.4 x 59	200	

<b>M 3.2</b>			Qty
MSHPZP32	3.2 x 65	200	

<b>M 3.5</b>			Qty
MSHPZP35	3.5 x 65	200	

<b>M 3.8</b>			Qty
MSHPZP38	3.8 x 75	200	

<b>M 4.5</b>			Qty
MSHPZP45	4.5 x 83	100	

<b>M 5</b>			Qty
MSHPZP5	5.0 x 96	100	

<b>M 6.2</b>			Qty
MSHPZP62	6.2 x 102	50	

<b>M 7</b>			Qty
MSHPZP7	7.0 x 104	25	

<b>M 7.9</b>			Qty
MSHPZP79	7.9 x 104	25	

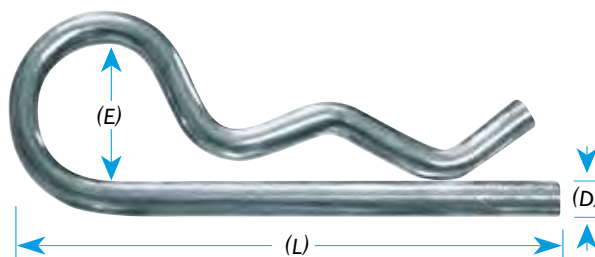

### R-Clip Dimension/Insertion Chart

DIA. (D)	PART NUMBER	LENGTH (L)	EYE (E)	DIA. DRILL SIZE	SHAFT MIN.	SHAFT MAX.	PACK SIZE
<b>1.2</b>	MSHPZP12	<b>15</b>	<b>3.18</b>	1.59	3.18	4.76	200
<b>1.6</b>	MSHPZP16	<b>33</b>	<b>7.94</b>	1.98	6.35	12.70	200
<b>2.0</b>	MSHPZP2	<b>40</b>	<b>9.53</b>	2.38	9.53	12.70	200
<b>2.4</b>	MSHPZP24	<b>59</b>	<b>15.88</b>	2.78	9.53	14.29	200
<b>3.2</b>	MSHPZP32	<b>65</b>	<b>14.29</b>	3.57	11.11	19.05	200
<b>3.5</b>	MSHPZP35	<b>65</b>	<b>15.88</b>	3.97	12.70	19.05	200

Dimensions listed may vary. Use as a guide only. Measurements are in Millimeters.

DIA. (D)	PART NUMBER	LENGTH (L)	EYE (E)	DIA. DRILL SIZE	SHAFT MIN.	SHAFT MAX.	PACK SIZE
<b>3.8</b>	MSHPZP38	<b>75</b>	<b>19.05</b>	3.97	15.88	25.40	200
<b>4.5</b>	MSHPZP45	<b>83</b>	<b>23.81</b>	4.76	15.88	25.40	100
<b>5</b>	MSHPZP5	<b>96</b>	<b>23.81</b>	5.50	15.88	25.40	100
<b>6.2</b>	MSHPZP62	<b>102</b>	<b>23.81</b>	6.75	19.05	25.40	50
<b>7</b>	MSHPZP7	<b>104</b>	<b>22.23</b>	7.54	19.05	25.40	25
<b>7.9</b>	MSHPZP79	<b>104</b>	<b>22.23</b>	8.33	22.23	25.40	25

Dimensions listed may vary. Use as a guide only. Measurements are in Millimeters.

**Shaft min/max represent the TOTAL diameter of the shaft used**



## PINS & CLIPS - Category II

### R-CLIP

#### Humpback Pins

#### STEEL - METRIC

#### Hanger/Hardware Packs

#### ZINC PLATED



M 1.6		Qty
MSHPZP16-HP	1.6 x 33	10
M 2		
MSHPZP2-HP	2.0 x 40	10
M 2.4		
MSHPZP24-HP	2.4 x 59	10
M 3.2		
MSHPZP32-HP	3.2 x 65	10
M 3.5		
MSHPZP35-HP	3.5 x 65	10
M 3.8		
MSHPZP38-HP	3.8 x 75	5

M 4.5		Qty
MSHPZP45-HP	4.5 x 83	5
M 5		
MSHPZP5-HP	5.0 x 96	5
M 6.2		
MSHPZP62-HP	6.2 x 102	5
M 7		
MSHPZP7-HP	7.0 x 104	5
M 7.9		
MSHPZP79-HP	7.9 x 104	5

### R-CLIP

#### Humpback Pins

#### RETAIL STAND

#### ZINC PLATED STEEL PACKS

#### Self standing black wire frame

Humpback Pin Counter Display Stand (Approx. 40cm wide, 75cm high, 12cm deep) - Contains 11 R-Clip sizes, each in a Snap Lock re-sealable plastic bag complete with barcoded header card (Each stand contains 5 Bags per size from 1.6 to 4.5 and 3 bags per size from 5.0 to 7.9mm). The stand also includes a Header Display Selection chart for ease of choosing the correct size.

#### R-Clip Retail Stand

HPSTAND	Total Packs	47
---------	-------------	----

#### HPSTAND CONTENTS AND QTY.

Size Dia.	Length	Quantity per pack	Packs per Stand
1.6mm	33mm	10	5
2.0mm	40mm	10	5
2.4mm	59mm	10	5
3.2mm	65mm	10	5
3.5mm	65mm	10	5
3.8mm	75mm	5	5
4.5mm	83mm	5	5
5.0mm	96mm	5	3
6.2mm	102mm	5	3
7.0mm	104mm	5	3
7.9mm	104mm	5	3



Stand dimensions  
40cm wide x 75cm high x 12cm deep

## PINS & CLIPS - Category II

### R-CLIP Humpback Pins STEEL ASSORTMENT PACK ZINC PLATED

R-CLIP Grab Kit		Qty
HPKIT8	Mixed Sizes	100



#### HPKIT8 CONTENTS AND QUANTITY

Part Number	Size	Qty. per Kit	Part Number	Size	Qty. per Kit
MSHPZP16	1.6 x 33	20	MSHPZP35	3.5 x 65	10
MSHPZP2	2 x 40	20	MSHPZP38	3.8 x 75	10
MSHPZP24	2.4 x 59	20	MSHPZP5	5 x 96	5
MSHPZP32	3.2 x 65	10	MSHPZP62	6.2 x 102	5

### R-CLIP Humpback Pins STAINLESS STEEL Grade G304



M 1.2		Qty
S4HPP12	1.2 x 15	100
M 1.6		Qty
S4HPP16	1.6 x 33	100
M 2		
S4HPP2	2.0 x 40	100

M 2.4		
S4HPP24	2.4 x 59	100
M 3.2		
S4HPP32	3.2 x 65	50
M 3.8		
S4HPP38	3.8 x 75	50

M 5		
S4HPP5	5.0 x 96	25
M 6.2		
S4HPP62	6.2 x 102	25

### R-CLIP STAINLESS STEEL Grade G304 Humpback Pins- METRIC Individual Hanger Packs

#### R-Clip - Stainless Steel Grade 304

Size	Quantity	Part Number
1.2 x 15mm	10 per pack	S4HPP12-HP
1.6 x 33mm	10 per pack	S4HPP16-HP
2.0 x 40mm	10 per pack	S4HPP2-HP
2.4 x 59mm	10 per pack	S4HPP24-HP
3.2 x 65mm	10 per pack	S4HPP32-HP
3.8 x 75mm	5 per pack	S4HPP38-HP
5.0 x 96mm	5 per pack	S4HPP5-HP
6.2 x 102mm	5 per pack	S4HPP62-HP





## PINS & CLIPS - Category II

### DOUBLE COIL R-CLIP Spring Tensioned STEEL - METRIC ZINC PLATED

M 2	Qty
MSDCHPZP2 2.0mm	25

M 3	Qty
MSDCHPZP3 3.0mm	25

M 4	Qty
MSDCHPZP4 4.0mm	25

M 5	Qty
MSDCHPZP5 5.0mm	25



M 6	Qty
MSDCHPZP6 6.0mm	25

M 8	Qty
MSDCHPZP8 8.0mm	25

### Double Coil R-Clip Dimension

Dia. (D)	Part Number	Length (L)	Eye Dia. (E)	Length (L2)	Shaft Min. <sup>2</sup>	Shaft Max. <sup>2</sup>
2	MSDCHPZP2	58.5	9.8	23.5	9.0	11.2
3	MSDCHPZP3	74.3	15.9	31.5	11.2	14.0
4	MSDCHPZP4	96.5	22.5	43.5	14.0	20.0
5	MSDCHPZP5	109.4	22.5	43.5	20.0	26.0
6	MSDCHPZP6	139.5	27.5	56.0	26.0	34.0
8	MSDCHPZP8	154.0	29.0	59.0	45.0	56.0

All measurements listed are in millimeters.

<sup>2</sup> Approx. size.

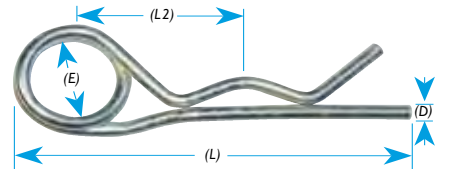

### HI-SPRING Spring Tensioned R-Clips STEEL - METRIC ZINC PLATED

M 3.5	Qty
MSSTHPZP35 3.5mm	25



### HAIR PIN RETAINER CLIP STEEL ZINC PLATED

No 3	Suits Shaft	Qty
MSHPRZP3 7/32		50

No 5	Qty
MSHPRZP5 5/16	50

No 8	Suits Shaft	Qty
MSHPRZP8 17/32		50

No 11	Qty
MSHPRZP11 7/8	50

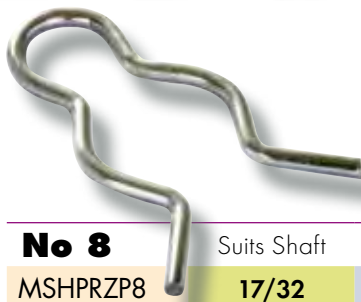

### HAIR PIN STEEL ASSORTMENT PACK

HAIRKIT4	Qty
Mixed Sizes	130

### HAIRKIT4 CONTENTS AND QTY.

Part Number	Size	Qty. per Kit
MSHPRZP3	No. 3	50
MSHPRZP5	No. 5	50
MSHPRZP8	No. 8	20
MSHPRZP11	No. 11	10



## PINS & CLIPS - Category II

### LINCH PINS STAINLESS STEEL MARINE GRADE 316 - Stamped A4

S6LPP45	4.5 x 40	10
S6LPP6	6 x 40	10
S6LPP8	8 x 40	10
S6LPP1140	11 x 40	5



### LINCH PINS STEEL MECHANICALLY GALVANISED

LPHP6	6 x 40	25
-------	--------	----

### LINCH PINS STEEL - METRIC Standard Packaging ZINC YELLOW PLATED



<b>M 4.5</b>		Qty
LPYP45	4.5 x 40	25
<b>M 6</b>		
LPYP6	6 x 40	25

<b>M 8</b>		
LPYP8	8 x 40	25

<b>M 11</b>		Qty
LPYP1140	11 x 40	25
LPYP1150	11 x 50	25
LPYP1170	11 x 70	25

### LINCH PINS STEEL ASSORTMENT PACK

<b>LINCH PIN Grab Kit</b>		Qty
LPKIT6	Mixed Sizes	24

#### LPKIT6 CONTENTS AND QTY.

Part Number	Size	Qty. per Kit
LPYP45	4.5	5
LPYP6	6	5
LPYP8	8	5
LPYP1140	11 x 40	3
LPYP1150	11 x 50	3
LPYP1170	11 x 70	3



### LINCH PINS STEEL - METRIC Hanger/Hardware Packs ZINC YELLOW PLATED



<b>M 4.5</b>		Qty
LPYP45-HP	4.5 x 40	5
<b>6</b>		
LPYP6-HP	6 x 40	5
<b>8</b>		
LPYP8-HP	8 x 40	5

<b>M 11</b>		Qty
LPYP1140-HP	11 x 40	3
LPYP1150-HP	11 x 50	3
LPYP1170-HP	11 x 70	3



## PINS & CLIPS - Category II

### LINCH PIN

**STAINLESS STEEL G316**  
**MARINE GRADE METRIC**  
**Hanger/Hardware**  
**Individual Packs**

#### Linch Pin - Stainless Steel 316 Marine Grade

Size	Quantity	Part Number
4.5 x 40mm	3 per pack	S6LPP45-HP
6 x 40mm	3 per pack	S6LPP6-HP
8 x 40mm	3 per pack	S6LPP8-HP



#### STANDARD LINCH PIN Mild Steel, Zinc Yellow

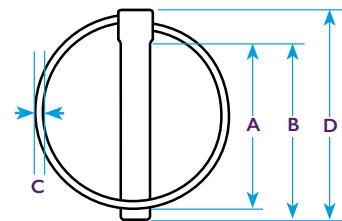

Pin Dia.	A	B	C	D
4.5mm	32	40	2.5	47
6mm	32	40	3	47
8mm	32	40	3	48
11mm	35	40	3.5	52
11mm	45	50	3.5	60
11mm	65	70	3.5	82

Dimensions listed may vary. Use a guide only.

#### SHAFT LOCKING PIN Round Type-Mild Steel, Zinc Yellow Suitable for Round Shafts up to 2" Dia.

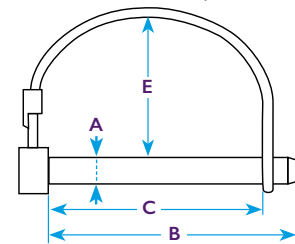

Pin Dia.	A	B	C	E
6mm	65	55	37	37
8mm	65	55	37	37
10mm	65	58	37	37

Dimensions listed may vary. Use a guide only.

#### SHAFT LOCKING PIN Square Type-Mild Steel, Zinc Yellow Suitable for Square Shafts up to 2" Dia.

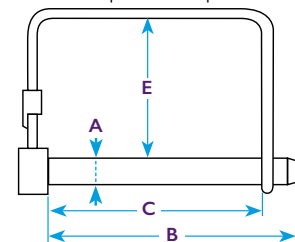

Pin Dia.	A	B	C	E
6mm	65	55	37	37
8mm	65	55	37	37
10mm	65	55	37	37

Dimensions listed may vary. Use a guide only.

58

**SHAFT LOCKING PINS**  
**Pipe (PTO) Clips**  
**- Suits 2 Shafts**  
**Standard Packaging**  
**STEEL - METRIC**  
**ZINC YELLOW PLATED**

M 6	Qty
SLYP6	25
M 8	Qty
SLYP8	25
M 10	Qty
SLYP10	25



**SHAFT LOCKING PINS**  
**Pipe (PTO) Clips**  
**- Suits 2 Shafts**  
**Standard Packaging**  
**STAINLESS STEEL**  
**GRADE 304 - METRIC**

M 6	Qty
S4SLP6	10
M 8	Qty
S4SLP8	10
M 10	Qty
S4SLP10	10





## PINS & CLIPS - Category II

**SHAFT LOCKING PINS**  
**SQUARE TYPE**  
**Pipe (PTO) Clips**  
**- Suits 2" Shafts**  
**Standard Packaging**  
**STEEL - METRIC**  
**ZINC YELLOW PLATED**



<b>M 6</b>		Qty
SLSQYP6	6mm	25
<b>M 8</b>		
SLSQYP8	8mm	25
<b>M 10</b>		
SLSQYP10	10mm	25

**SHAFT LOCKING PINS**  
**Pipe (PTO) Clips - Suits 2"**  
**Shafts - Hanger/Hardware**  
**Packs**  
**STEEL - METRIC**  
**ZINC YELLOW PLATED**



<b>6</b>		Qty
SLYP6-HP	6mm	3
<b>8</b>		
SLYP8-HP	8mm	3
<b>10</b>		
SLYP10-HP	10mm	3

**SHAFT LOCKING PINS**  
**- Suits 2" Shafts -**  
**STAINLESS STEEL Grade**  
**G304 METRIC**  
**Hanger/Hardware**  
**Individual Packs**

### Shaft Lock Pin - Stainless Steel 304 Grade

Size	Quantity	Part Number
M6	2 per pack	S4SLP6-HP
M8	2 per pack	S4SLP8-HP
M10	2 per pack	S4SLP10-HP



## PINS & CLIPS - Category II

### LINCH PIN & SHAFT LOCKING PIN RETAIL STAND

**ZINC YELLOW PLATED**  
Self standing black wire frame

Linch Pin & Shaft Locking Pin Counter Display Stand (Approx. 40cm wide, 75cm high, 12cm deep)  
- Contains 9 Linch & Shaft Pin sizes, each in a Snap Lock re-sealable plastic bag complete with barcoded header card (Linch Pin Diameters range from 4.5mm to 11mm, and the Shaft Locking Pins range from 6mm to 10mm). The stand also includes a Header Display Card for ease of choosing the correct size)

#### Part Number

LSLSTAND      Packs listed below

#### LINCH PIN Zinc Yellow Plated

Size Dia.	Quantity per pack	Packs per Stand
4.5 x 40mm	5	6
6 x 40mm	5	6
8 x 40mm	5	3
11 x 40mm	5	3
11 x 50mm	5	3
11 x 70mm	5	3

#### SHAFT LOCKING PIN Zinc Yellow Plated

6mm	3	3
8mm	3	3
10mm	3	3



Stand dimensions  
40cm wide x 75cm high x 20cm deep



## PINS & CLIPS - Category II

### STAINLESS STEEL HANG PACK SWIVEL STAND

Linch Pin, Shaft Lock Pins  
and R-Clips in individual  
packs - **METRIC**

Self standing black  
wire frame on swivel base

#### Part Number

SSPINSTAND Packs listed below

#### Linch Pin - Stainless Steel 316 Marine Grade

Size Dia.	Quantity per pack	Packs per Stand	Part Number
4.5 x 40mm	3	6	S6LPP45-HP
6 x 40mm	3	3	S6LPP6-HP
8 x 40mm	3	3	S6LPP8-HP

#### Shaft Lock Pin - Stainless Steel 304 Grade

M6	2	6	S4SLP6-HP
M8	2	3	S4SLP8-HP
M10	2	3	S4SLP10-HP

#### R-Clip - Stainless Steel 304 Grade

1.2 x 15mm	10	3	S4HPP12-HP
1.6 x 33mm	10	3	S4HPP16-HP
2.0 x 40mm	10	3	S4HPP2-HP
2.4 x 59mm	10	3	S4HPP24-HP
3.2 x 65mm	10	3	S4HPP32-HP
3.8 x 75mm	5	3	S4HPP38-HP
5.0 x 96mm	5	3	S4HPP5-HP
6.2 x 102mm	5	3	S4HPP62-HP



Stand dimensions  
20 x 20 x 70cm

[www.hitechfasteners.com.au](http://www.hitechfasteners.com.au)



## PINS & CLIPS - Category II

### CLEVIS PINS STEEL - IMPERIAL ZINC PLATED



<b>1/4</b>		Qty
MSCLZP1434	1/4 x 3/4	25
MSCLZP1478	1/4 x 7/8	25
MSCLZP141	1/4 x 1	25
MSCLZP14114	1/4 x 1 1/4	25
MSCLZP14112	1/4 x 1 1/2	25

<b>5/16</b>		
MSCLZP51634	5/16 x 3/4	25
MSCLZP51678	5/16 x 7/8	25
MSCLZP5161	5/16 x 1	25
MSCLZP516114	5/16 x 1 1/4	25
MSCLZP516112	5/16 x 1 1/2	25
MSCLZP516134	5/16 x 1 3/4	25
MSCLZP5162	5/16 x 2	25

<b>3/8</b>		Qty
MSCLZP381	3/8 x 1	25
MSCLZP38118	3/8 x 1 1/8	25
MSCLZP38114	3/8 x 1 1/4	25
MSCLZP38112	3/8 x 1 1/2	25
MSCLZP382	3/8 x 2	25

<b>7/16</b>		
MSCLZP716138	7/16 x 1 3/8	25
MSCLZP716112	7/16 x 1 1/2	25

<b>1/2</b>		Qty
MSCLZP12114	1/2 x 1 1/4	25
MSCLZP12138	1/2 x 1 3/8	25
MSCLZP12112	1/2 x 1 1/2	25
MSCLZP122	1/2 x 2	25

62



<b>CLEVIS PIN Grab Kit</b>	Qty
CPKIT16	16 Mixed Sizes 230

#### CPKIT16 CONTENTS AND QUANTITY

Part Number	Size	Qty. per Kit	Part Number	Size	Qty. per Kit
MSCLZP1434	1/4 x 3/4	20	MSCLZP381	3/8 x 1	10
MSCLZP1478	1/4 x 7/8	20	MSCLZP38118	3/8 x 1 1/8	10
MSCLZP141	1/4 x 1	20	MSCLZP38112	3/8 x 1 1/2	10
MSCLZP14114	1/4 x 1 1/4	20	MSCLZP382	3/8 x 2	10
MSCLZP14112	1/4 x 1 1/2	20	MSCLZP716112	7/16 x 1 1/2	10
MSCLZP51634	5/16 x 3/4	20	MSCLZP12114	1/2 x 1 1/4	10
MSCLZP5161	5/16 x 1	20	MSCLZP12112	1/2 x 1 1/2	10
MSCLZP516114	5/16 x 1 1/4	10			
MSCLZP516134	5/16 x 1 3/4	10			



### Brass Flat Washer

63

#### BRASS WASHER FLAT - METRIC

<b>M 3</b>		Qty
BRFWP3	M3 x 7 x 0.5mm	200
<b>M 4</b>		
BRFWP4	M4 x 9 x 0.8mm	200

<b>M 5</b>		Qty
BRFWP5	M5 x 10 x 0.8mm	200
<b>M 6</b>		
BRFWP6	M6 x 12.5 x 1mm	100

<b>M 8</b>		
BRFWP8	M8 x 17 x 1.2mm	50

<b>M 10</b>		Qty
BRFWP10	M10 x 21 x 1.2mm	25
<b>M 12</b>		
BRFWP12M	M12 x 24 x 1.6mm	25

#### BRASS WASHER FLAT - IMPERIAL

<b>1/8</b>		Qty
BRFWP18516	1/8 x 5/16 x 21g	200
BRFWP1838	1/8 x 3/8 x 21g	200
<b>5/32</b>		
BRFWP53238	5/32 x 3/8 x 21g	200
BRFWP532716	5/32 x 7/16 x 21g	200

<b>3/16</b>		Qty
BRFWP316716	3/16 x 7/16 x 21g	200
BRFWP31612	3/16 x 1/2 x 21g	200
<b>1/4</b>		
BRFWP1412	1/4 x 1/2 x 21g	100
BRFWP1458	1/4 x 5/8 x 19g	100
BRFWP14916	1/4 x 9/16 x 19g	100

<b>5/16</b>		Qty
BRFWP51658	5/16 x 5/8 x 18g	50
BRFWP51634	5/16 x 3/4 x 18g	50
<b>3/8</b>		
BRFWP3834	3/8 x 3/4 x 16g	25
BRFWP3878	3/8 x 7/8 x 18g	25

#### Specifications:

Metric: AS 1234  
Imperial: BS 3410

### Post Combination Square/Phillips Case Hardened Zinc Alloy (Super Zinc) Plated Machine Screws

64



**Pan Head  
POST SQUARE/PHILLIPS  
DRIVE STEEL - METRIC  
ZINC ALLOY PLATED**

M 6		Qty
MSPQPAP612	6 x 12	200
MSPQPAP616	6 x 16	200
MSPQPAP620	6 x 20	200
MSPQPAP625	6 x 25	200



**Countersunk Head  
POST SQUARE/PHILLIPS  
DRIVE STEEL - METRIC  
ZINC ALLOY PLATED**

M 6		Qty
MSCQPAP612	6 x 12	200
MSCQPAP616	6 x 16	200
MSCQPAP620	6 x 20	200
MSCQPAP625	6 x 25	200



Security Screw Grab Kit	Qty
SECKIT8	8 Mixed Sizes 200

#### Specifications:

Metric: AS 1427

#### Zinc Alloy Plating Performance vs other plating

HDG (Hot Dipped Galvanising)  
84um plating thickness - approx 910 hours Salt  
Spray tested before Red Rust

#### Mechanical Galvanising

15um plating thickness - approx 500 hours + Salt  
Spray tested before Red Rust

#### Super Zinc (Zinc Alloy)

15um plating thickness - approx 1000 hours Salt  
Spray tested before Red Rust

#### SECKIT8 CONTENTS AND QTY.

Part Number	Size	Qty. per Kit
MSCQPAP612	M6 x 12	25
MSCQPAP616	M6 x 16	25
MSCQPAP620	M6 x 20	25
MSCQPAP625	M6 x 25	25
MSPQPAP612	M6 x 12	25
MSPQPAP616	M6 x 16	25
MSPQPAP620	M6 x 20	25
MSPQPAP625	M6 x 25	25

### Round Head Zinc Clear



65

### Round Head U-DRIVE STEEL ZINC PLATED CASE HARDENED



<b>00G</b>		Qty
UDS0018	<b>00G X 1/8</b>	1000
UDS00316	<b>00G X 3/16</b>	1000
UDS0014	<b>00G X 1/4</b>	1000

<b>0G</b>		Qty
UDS018	<b>0G X 1/8</b>	1000
UDS0316	<b>0G X 3/16</b>	1000
UDS014	<b>0G X 1/4</b>	1000

<b>2G</b>		Qty
UDS218	<b>2G X 1/8</b>	1000
UDS2316	<b>2G X 3/16</b>	1000
UDS214	<b>2G X 1/4</b>	1000
UDS2516	<b>2G X 5/16</b>	1000

<b>4G</b>		Qty
UDS4316	<b>4G X 3/16</b>	1000
UDS414	<b>4G X 1/4</b>	1000
UDS4516	<b>4G X 5/16</b>	1000
UDS438	<b>4G X 3/8</b>	1000

<b>6G</b>		Qty
UDS614	<b>6G X 1/4</b>	1000
UDS6516	<b>6G X 5/16</b>	1000
UDS638	<b>6G X 3/8</b>	1000
UDS612	<b>6G X 1/2</b>	1000

<b>8G</b>		Qty
UDS838	<b>8G X 3/8</b>	1000
UDS812	<b>8G X 1/2</b>	1000

<b>10G</b>		Qty
UDS1038	<b>10G X 3/8</b>	1000
UDS1012	<b>10G X 1/2</b>	1000
UDS1058	<b>10G X 5/8</b>	1000

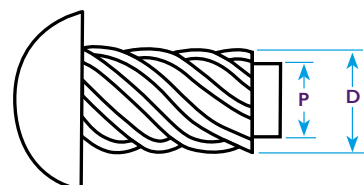

**U-DRIVE Screw Dimensinal Chart**

Gauge	D Outside Dia.		P Pilot Dia.	Recommended Hole Size	
	Max	Max		Drill Size No.	Hole Dia.
00	0.06	0.049	0.046	55	0.052
0	0.075	0.063	0.06	51	0.067
2	0.1	0.083	0.08	44	0.086
4	0.116	0.096	0.092	37	0.104
6	0.14	0.116	0.112	31	0.12
8	0.167	0.136	0.132	27	0.144
10	0.182	0.15	0.146	20	0.161

Dimensions listed may vary. Use a a guide only.

### Specifications:

ANSI B 18.6.4

# DRIVER BITS

## I/4 A/F

Category 15

66

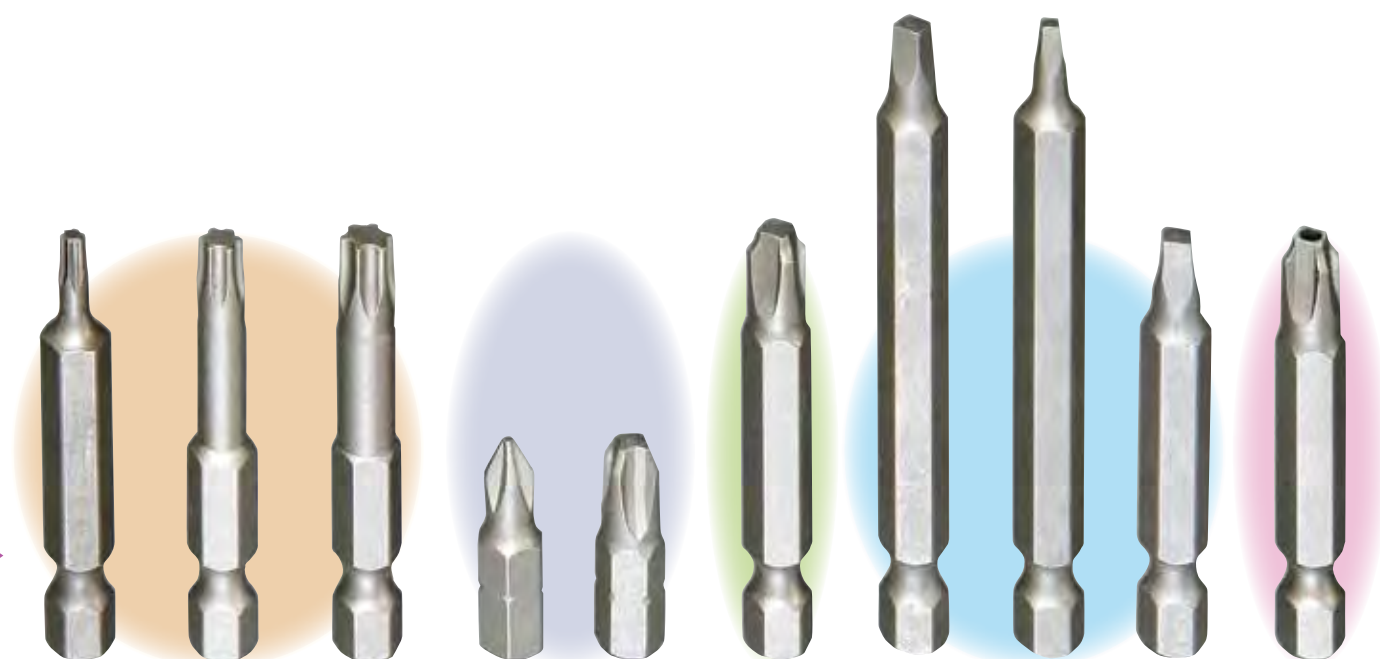

6 Lobe

Phillips

Combination

Square

Security

6 Lobe		Qty
TDB3	T10	1
TDB4	T20	1
TDB5	T25	1
TDB6	T30	1
Phillips		
PDB0	#0 x 25mm	1
PDB1	#1 x 25mm	1
PDB2	#2 x 25mm	1
PDB3	#3 x 25mm	1

Comb.Square/Phil		Qty
CDB050	#0 x 50mm	1
CDB150	#1 x 50mm	1
CDB175	#1 x 75mm	1
CDB1100	#1 x 100mm	1
CDB250	#2 x 50mm	1
CDB275	#2 x 75mm	1
CDB2100	#2 x 100mm	1
CDB350	#3 x 50mm	1

Square		Qty
SDB0	#0 x 25mm	1
SDB075	#0 x 75mm	1
SDB1	#1 x 25mm	1
SDB175	#1 x 75mm	1
SDB2	#2 x 25mm	1
SDB275	#2 x 75mm	1
SDB3	#3 x 25mm	1
SDB375	#3 x 75mm	1

### Security Post Square/Phil

PCDB250	#2 x 50mm	1
---------	-----------	---



### Solid Brass Wood Screws

### Steel Brass Plated Wood Screws Case Hardened



67

68

#### Countersunk Head SOLID BRASS Wood Screws SLOT



2#		Qty
BRWSCSP238	2# x 3/8	200
3#		
BRWSCSP338	3# x 3/8	200
BRWSCSP312	3# x 1/2	200
4#		
BRWSCSP438	4# x 3/8	200
BRWSCSP412	4# x 1/2	200
BRWSCSP458	4# x 5/8	200

6#		Qty
BRWSCSP612	6# x 1/2	200
BRWSCSP658	6# x 5/8	200
BRWSCSP634	6# x 3/4	200
BRWSCSP61	6# x 1	200
BRWSCSP6114	6# x 1 1/4	200
BRWSCSP6112	6# x 1 1/2	200

8#		
BRWSCSP834	8# x 3/4	200
BRWSCSP81	8# x 1	200

8# Continued		Qty
BRWSCSP8114	8# x 1 1/4	200
BRWSCSP8112	8# x 1 1/2	200

10#		
BRWSCSP101	10# x 1	200
BRWSCSP10114	10# x 1 1/4	200
BRWSCSP10112	10# x 1 1/2	200

12#		
BRWSCSP12112	12# x 1 1/2	200
BRWSCSP122	12# x 2	200

#### Countersunk Head PHILLIPS SOLID BRASS TWIN FAST Wood Screws

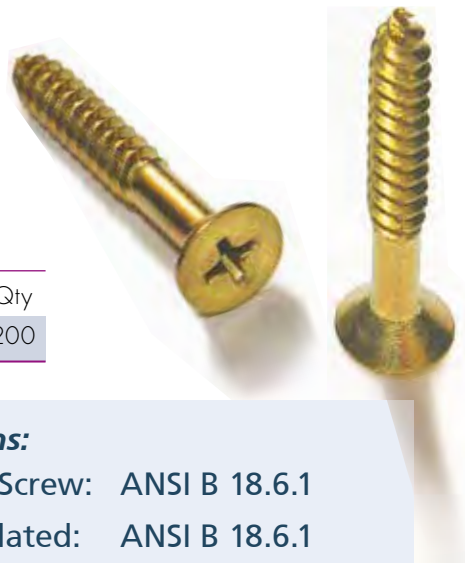

12#		Qty
BRWSCP12112	12# x 1 1/2	200

#### Specifications:

Brass Wood Screw: ANSI B 18.6.1

Steel Brass Plated: ANSI B 18.6.1



## SCREWS FOR TIMBER - Category 16

### Countersunk Head PHILLIPS Wood Screws STEEL BRASS PLATED *Not solid brass*



4#		Qty
MSWSCPBP412	4# x 1/2	200
MSWSCPBP434	4# x 3/4	200
6#		
MSWSCPBP634	6# x 3/4	200
MSWSCPBP61	6# x 1	200
MSWSCPBP6114	6# x 1 1/4	200
MSWSCPBP6112	6# x 1 1/2	200

8#		Qty
MSWSCPBP834	8# x 3/4	200
MSWSCPBP81	8# x 1	200
MSWSCPBP8114	8# x 1 1/4	200
MSWSCPBP8112	8# x 1 1/2	200

10#		Qty
MSWSCPBP101	10# x 1	200
MSWSCPBP10114	10# x 1 1/4	200
MSWSCPBP10112	10# x 1 1/2	200

68

### Round Head PHILLIPS/SLOT COMBINATION Wood Screws STEEL BRASS PLATED *Not solid brass*



4#		Qty
MSWSRCBP412	4# x 1/2	200
MSWSRCBP434	4# x 3/4	200
6#		
MSWSRCBP634	6# x 3/4	200
MSWSRCBP61	6# x 1	200
MSWSRCBP6114	6# x 1 1/4	200
MSWSRCBP6112	6# x 1 1/2	200

8#		Qty
MSWSRCBP834	8# x 3/4	200
MSWSRCBP81	8# x 1	200
MSWSRCBP8114	8# x 1 1/4	200
MSWSRCBP8112	8# x 1 1/2	200

10#		Qty
MSWSRCBP101	10# x 1	200
MSWSRCBP10114	10# x 1 1/4	200
MSWSRCBP10112	10# x 1 1/2	200

# HEXAGON MILD STEEL BOLTS & SET SCREWS

Category 17

## Hexagon Bolt & Nut



70

## Hexagon Set Screws



72

69

### ***Plating / Material:***

Commercial Grade Steel Zinc Plated

### ***Specifications:***

Metric Hex Bolt:	AS 1111
Metric Hex Nut:	AS 1112
Imperial Hex Bolt:	AS 2451
Imperial Hex Nut:	AS 2451
Metric Hex Set Screw:	M4 AS 1110
Metric Hex Set Screw:	M5-M10 AS 1111
Imperial Hex Set Screw:	3/16 Ref. Drawing
Imperial Hex Set Screw:	1/4-3/8 AS 2451

# HEXAGON MILD STEEL BOLTS & SET SCREWS - Category 17

**Hexagonal Head  
BOLT & NUT**  
**STEEL - METRIC**  
**Class 4.6**  
**ZINC PLATED**



<b>M 6</b>		Qty
MSHBNZP620*	<b>6 x 20</b>	200
MSHBNZP625	<b>6 x 25</b>	200
MSHBNZP630	<b>6 x 30</b>	200
MSHBNZP635	<b>6 x 35</b>	200
MSHBNZP640	<b>6 x 40</b>	200
MSHBNZP645	<b>6 x 45</b>	200
MSHBNZP650	<b>6 x 50</b>	200
MSHBNZP655	<b>6 x 55</b>	150
MSHBNZP660	<b>6 x 60</b>	150
MSHBNZP665	<b>6 x 65</b>	150
MSHBNZP670	<b>6 x 70</b>	150
MSHBNZP675	<b>6 x 75</b>	150
MSHBNZP680	<b>6 x 80</b>	150
MSHBNZP685	<b>6 x 85</b>	150
MSHBNZP690	<b>6 x 90</b>	150
MSHBNZP6100	<b>6 x 100</b>	150
MSHBNZP6120	<b>6 x 120</b>	100
MSHBNZP6130	<b>6 x 130</b>	100
MSHBNZP6140	<b>6 x 140</b>	100
MSHBNZP6150	<b>6 x 150</b>	100

<b>M 8</b>		Qty
MSHBNZP820*	<b>8 x 20</b>	200
MSHBNZP825*	<b>8 x 25</b>	200
MSHBNZP830	<b>8 x 30</b>	200
MSHBNZP835	<b>8 x 35</b>	200
MSHBNZP840	<b>8 x 40</b>	200
MSHBNZP845	<b>8 x 45</b>	150
MSHBNZP850	<b>8 x 50</b>	150
MSHBNZP855	<b>8 x 55</b>	150
MSHBNZP860	<b>8 x 60</b>	150
MSHBNZP865	<b>8 x 65</b>	150
MSHBNZP870	<b>8 x 70</b>	100
MSHBNZP875	<b>8 x 75</b>	100
MSHBNZP880	<b>8 x 80</b>	100
MSHBNZP885	<b>8 x 85</b>	100
MSHBNZP890	<b>8 x 90</b>	100
MSHBNZP8100	<b>8 x 100</b>	100
MSHBNZP8120	<b>8 x 120</b>	100
MSHBNZP8130	<b>8 x 130</b>	100
MSHBNZP8140	<b>8 x 140</b>	100
MSHBNZP8150	<b>8 x 150</b>	100

<b>M 10</b>		Qty
MSHBNZP1020*	<b>10 x 20</b>	150
MSHBNZP1025*	<b>10 x 25</b>	150
MSHBNZP1030*	<b>10 x 30</b>	150
MSHBNZP1035	<b>10 x 35</b>	150
MSHBNZP1040	<b>10 x 40</b>	150
MSHBNZP1045	<b>10 x 45</b>	150
MSHBNZP1050	<b>10 x 50</b>	75
MSHBNZP1055	<b>10 x 55</b>	75
MSHBNZP1060	<b>10 x 60</b>	75
MSHBNZP1065	<b>10 x 65</b>	75
MSHBNZP1070	<b>10 x 70</b>	75
MSHBNZP1075	<b>10 x 75</b>	75
MSHBNZP1080	<b>10 x 80</b>	75
MSHBNZP1085	<b>10 x 85</b>	50
MSHBNZP1090	<b>10 x 90</b>	50
MSHBNZP10100	<b>10 x 100</b>	50
MSHBNZP10110	<b>10 x 110</b>	50
MSHBNZP10120	<b>10 x 120</b>	50
MSHBNZP10130	<b>10 x 130</b>	50
MSHBNZP10140	<b>10 x 140</b>	50
MSHBNZP10150	<b>10 x 150</b>	50

# HEXAGON MILD STEEL BOLTS & SET SCREWS - Category 17

**Hexagonal Head  
BOLT & NUT  
STEEL - IMPERIAL  
Grade 2  
ZINC PLATED**



<b>1/4</b>		Qty
MSHBNZP1434*	1/4 x 3/4	200
MSHBNZP141	1/4 x 1	200
MSHBNZP14114	1/4 x 1 1/4	200
MSHBNZP14112	1/4 x 1 1/2	200
MSHBNZP14134	1/4 x 1 3/4	200
MSHBNZP142	1/4 x 2	200
MSHBNZP14214	1/4 x 2 1/4	150
MSHBNZP14212	1/4 x 2 1/2	150
MSHBNZP14234	1/4 x 2 3/4	150
MSHBNZP143	1/4 x 3	150
MSHBNZP14312	1/4 x 3 1/2	150
MSHBNZP144	1/4 x 4	150
MSHBNZP14412	1/4 x 4 1/2	150
MSHBNZP145	1/4 x 5	100
MSHBNZP14512	1/4 x 5 1/2	100
MSHBNZP146	1/4 x 6	100

<b>5/16</b>		Qty
MSHBNZP51634*	5/16 x 3/4	150
MSHBNZP5161*	5/16 x 1	150
MSHBNZP516114	5/16 x 1 1/4	150
MSHBNZP516112	5/16 x 1 1/2	150
MSHBNZP516134	5/16 x 1 3/4	150
MSHBNZP5162	5/16 x 2	150
MSHBNZP516214	5/16 x 2 1/4	150
MSHBNZP516212	5/16 x 2 1/2	150
MSHBNZP516234	5/16 x 2 3/4	100
MSHBNZP5163	5/16 x 3	100
MSHBNZP516312	5/16 x 3 1/2	100
MSHBNZP5164	5/16 x 4	100
MSHBNZP516412	5/16 x 4 1/2	100
MSHBNZP5165	5/16 x 5	100
MSHBNZP516512	5/16 x 5 1/2	100
MSHBNZP5166	5/16 x 6	100

<b>3/8</b>		Qty
MSHBNZP3834*	3/8 x 3/4	150
MSHBNZP381*	3/8 x 1	150
MSHBNZP38114	3/8 x 1 1/4	150
MSHBNZP38112	3/8 x 1 1/2	150
MSHBNZP38134	3/8 x 1 3/4	150
MSHBNZP382	3/8 x 2	100
MSHBNZP38214	3/8 x 2 1/4	100
MSHBNZP38212	3/8 x 2 1/2	100
MSHBNZP38234	3/8 x 2 3/4	100
MSHBNZP383	3/8 x 3	100
MSHBNZP38312	3/8 x 3 1/2	50
MSHBNZP384	3/8 x 4	50
MSHBNZP38412	3/8 x 4 1/2	50
MSHBNZP385	3/8 x 5	50
MSHBNZP38512	3/8 x 5 1/2	50
MSHBNZP386	3/8 x 6	50

\* Supplied as SET SCREWS

# HEXAGON MILD STEEL BOLTS & SET SCREWS - Category 17

**Hexagonal Head**  
**SET SCREW**  
**STEEL - METRIC**  
**Class 4.6**  
**ZINC PLATED**



<b>M 4</b>		Qty
MSHSZP410	<b>4 x 10</b>	200
MSHSZP412	<b>4 x 12</b>	200
MSHSZP416	<b>4 x 16</b>	200
MSHSZP420	<b>4 x 20</b>	200
MSHSZP425	<b>4 x 25</b>	200
MSHSZP430	<b>4 x 30</b>	200
MSHSZP435	<b>4 x 35</b>	200
MSHSZP440	<b>4 x 40</b>	200
MSHSZP445	<b>4 x 45</b>	200
MSHSZP450	<b>4 x 50</b>	200

<b>M 5</b>		Qty
MSHSZP510	<b>5 x 10</b>	200
MSHSZP512	<b>5 x 12</b>	200
MSHSZP516	<b>5 x 16</b>	200
MSHSZP520	<b>5 x 20</b>	200
MSHSZP525	<b>5 x 25</b>	200
MSHSZP530	<b>5 x 30</b>	200
MSHSZP535	<b>5 x 35</b>	200
MSHSZP540	<b>5 x 40</b>	200
MSHSZP545	<b>5 x 45</b>	200
MSHSZP550	<b>5 x 50</b>	200

<b>M 6</b>		Qty
MSHSZP610	<b>6 x 10</b>	200
MSHSZP612	<b>6 x 12</b>	200
MSHSZP616	<b>6 x 16</b>	200
MSHSZP620	<b>6 x 20</b>	200
MSHSZP625	<b>6 x 25</b>	200
MSHSZP630	<b>6 x 30</b>	200
MSHSZP635	<b>6 x 35</b>	200
MSHSZP640	<b>6 x 40</b>	200
MSHSZP645	<b>6 x 45</b>	200
MSHSZP650	<b>6 x 50</b>	200
MSHSZP665	<b>6 x 65</b>	150
MSHSZP675	<b>6 x 75</b>	150

<b>M 8</b>		Qty
MSHSZP812	<b>8 x 12</b>	200
MSHSZP816	<b>8 x 16</b>	200
MSHSZP820	<b>8 x 20</b>	200
MSHSZP825	<b>8 x 25</b>	200
MSHSZP830	<b>8 x 30</b>	200
MSHSZP835	<b>8 x 35</b>	200
MSHSZP840	<b>8 x 40</b>	200
MSHSZP845	<b>8 x 45</b>	200
MSHSZP850	<b>8 x 50</b>	200
MSHSZP865	<b>8 x 65</b>	150
MSHSZP875	<b>8 x 75</b>	150

<b>M 10</b>		Qty
MSHSZP1012	<b>10 x 12</b>	150
MSHSZP1016	<b>10 x 16</b>	150
MSHSZP1020	<b>10 x 20</b>	150
MSHSZP1025	<b>10 x 25</b>	150
MSHSZP1030	<b>10 x 30</b>	150
MSHSZP1035	<b>10 x 35</b>	150
MSHSZP1040	<b>10 x 40</b>	150
MSHSZP1045	<b>10 x 45</b>	75
MSHSZP1050	<b>10 x 50</b>	75
MSHSZP1065	<b>10 x 65</b>	75
MSHSZP1075	<b>10 x 75</b>	75
MSHSZP1090	<b>10 x 90</b>	50
MSHSZP10100	<b>10 x 100</b>	50

# HEXAGON MILD STEEL BOLTS & SET SCREWS - Category 17

**Hexagonal Head  
SET SCREW  
STEEL - IMPERIAL  
Grade 2  
ZINC PLATED**



<b>3/16</b>		Qty
MSHSZP31638	3/16 x 3/8	200
MSHSZP31612	3/16 x 1/2	200
MSHSZP31658	3/16 x 5/8	200
MSHSZP31634	3/16 x 3/4	200
MSHSZP3161	3/16 x 1	200
MSHSZP316114	3/16 x 1 1/4	200
MSHSZP316112	3/16 x 1 1/2	200
MSHSZP3162	3/16 x 2	200

<b>1/4</b>		
MSHSZP1438	1/4 x 3/8	200
MSHSZP1412	1/4 x 1/2	200
MSHSZP1458	1/4 x 5/8	200
MSHSZP1434	1/4 x 3/4	200
MSHSZP141	1/4 x 1	200
MSHSZP14114	1/4 x 1 1/4	200
MSHSZP14112	1/4 x 1 1/2	200
MSHSZP14134	1/4 x 1 3/4	200
MSHSZP142	1/4 x 2	200
MSHSZP14214	1/4 x 2 1/4	150
MSHSZP14212	1/4 x 2 1/2	150
MSHSZP143	1/4 x 3	150

<b>5/16</b>		Qty
MSHSZP51612	5/16 x 1/2	200
MSHSZP51658	5/16 x 5/8	200
MSHSZP51634	5/16 x 3/4	200
MSHSZP5161	5/16 x 1	200
MSHSZP516114	5/16 x 1 1/4	200
MSHSZP516112	5/16 x 1 1/2	200
MSHSZP516134	5/16 x 1 3/4	200
MSHSZP5162	5/16 x 2	200
MSHSZP516214	5/16 x 2 1/4	150
MSHSZP516212	5/16 x 2 1/2	150
MSHSZP5163	5/16 x 3	150

<b>3/8</b>		Qty
MSHSZP3812	3/8 x 1/2	200
MSHSZP3858	3/8 x 5/8	200
MSHSZP3834	3/8 x 3/4	200
MSHSZP381	3/8 x 1	200
MSHSZP38114	3/8 x 1 1/4	200
MSHSZP38112	3/8 x 1 1/2	200
MSHSZP38134	3/8 x 1 3/4	150
MSHSZP382	3/8 x 2	150
MSHSZP38212	3/8 x 2 1/2	150
MSHSZP383	3/8 x 3	150
MSHSZP38312	3/8 x 3 1/2	100
MSHSZP384	3/8 x 4	100



***Contact us for your nearest stockist.***

***Our service never stops.***



Unit 4, 12 Cunningham Street  
Moorebank NSW 2170  
PO Box 332 Moorebank NSW 1875  
Phone: 02 9602 6200  
email: [info@hitechfasteners.com.au](mailto:info@hitechfasteners.com.au)  
[www.hitechfasteners.com.au](http://www.hitechfasteners.com.au)

HITECH Fasteners Aust Pty Ltd  
ABN 50 783 784 864